

# CREATE

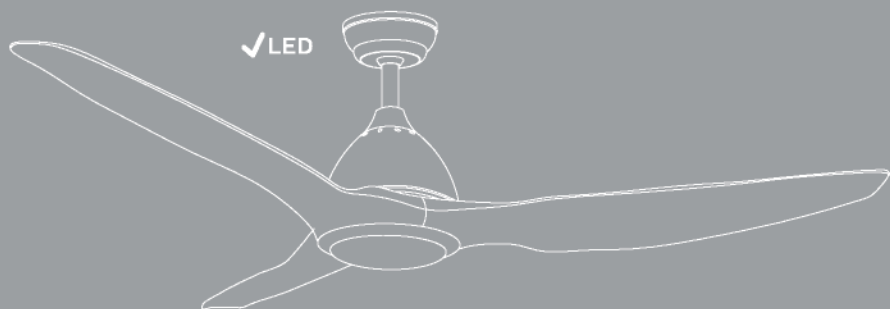

CEILING FAN

---

**ASSEMBLY MANUAL**

[illegible]

# CREATE



## EN

To download this user guide in your language, visit our website:  
[www.ikohs.com/uk](http://www.ikohs.com/uk)



## ES

Para descargar el manual en su idioma, visite nuestra web:  
[www.ikohs.com/es](http://www.ikohs.com/es)



## PT

Para baixar o manual no seu idiomas, visite nosso site:  
[www.ikohs.com/pt](http://www.ikohs.com/pt)



## FR

Pour télécharger le manuel dans votre langue, visitez notre site Web:  
[www.ikohs.com/fr](http://www.ikohs.com/fr)



## IT

Per scaricare il manuale nella sua lingua, visitare il nostro sito Web:  
[www.ikohs.com/it](http://www.ikohs.com/it)



## DE

Um das Handbuch in Ihrer Sprachen herunterzuladen, besuchen Sie unsere Website:  
[www.ikohs.com/de](http://www.ikohs.com/de)



## NL

Bezoek onze website om de handleiding in uw taal te downloaden:  
[www.ikohs.com/nl](http://www.ikohs.com/nl)



## PL

Aby pobrać instrukcję w swoim języku, odwiedź naszą stronę internetową:  
[www.ikohs.com/pl](http://www.ikohs.com/pl)

## THIS MANUAL IS FOR THE FOLLOWING MODELS:



## INDEX

---

Box contents	5
Step 1. Wood ceiling	6
Step 1. Concrete ceiling	7
Step 1. False ceiling	9
Choice of height	10
Step 2. Main body assembly	11
Step 3. Ground connection	13
Step 4. Driver connection	14
Step 5. Assembling the blades	15
Step 6. Decorative element placement	17
OPTION WITH LED KIT	18
Step 7. Led plate connection	18
Step 8. Lamp cover placement	19
OPTION WITHOUT LED KIT	20
Step 7. Attaching the decorative cover	20
Blade balancing kit	22



# BOX CONTENTS



**ATTENTION!** Before starting the assembly, remember to disconnect the light from the electrical panel so as not to suffer an electric shock.

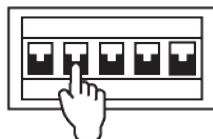

# STEP 1. WOOD CEILING

## PARTS AND TOOLS

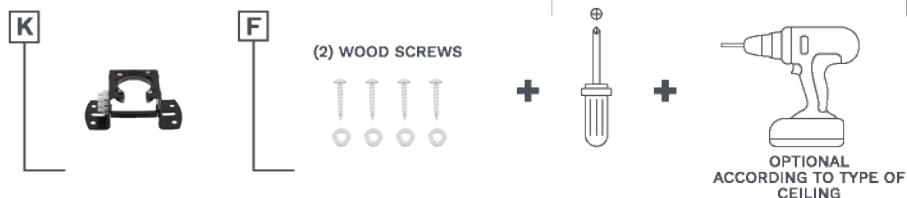

Mark with a pencil the 4 holes of the piece K in the ceiling.

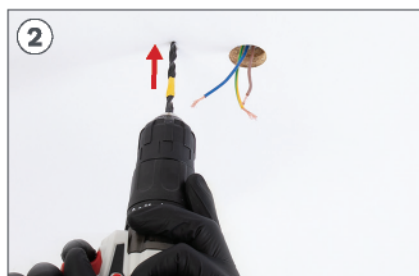

If necessary, depending on the type of ceiling, you will need to use a drill to make the hole in the wood.

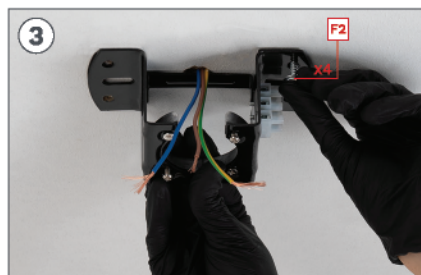

Place the washer and then the screw F2.

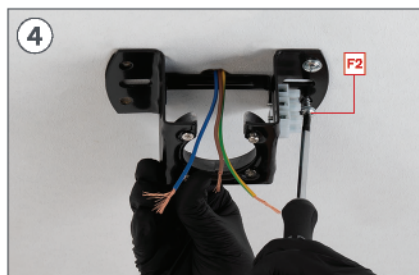

With the help of the screwdriver, tighten the screws F2.



Repeat this step for the remaining holes.

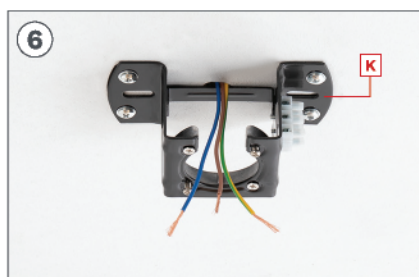

Make sure piece K is perfectly fixed to the ceiling and that no cables are trapped.

# STEP 1. CONCRETE CEILING

## PARTS AND TOOLS

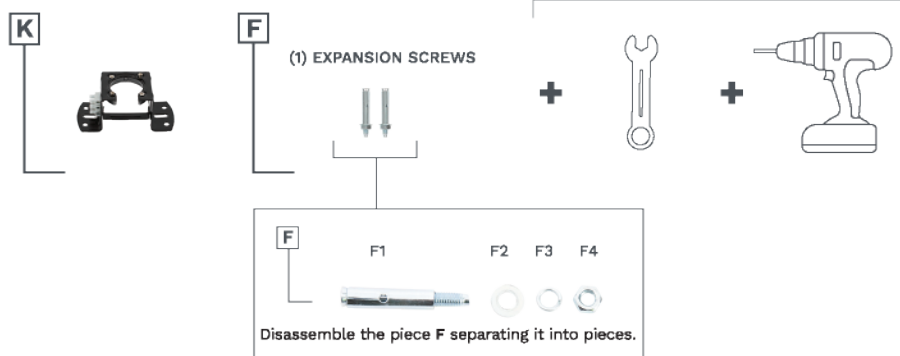

Mark with a pencil the 2 central holes of the piece **K** on the ceiling using the same piece as a guide.



With the help of a drill, make the two corresponding holes with a Ø8 mm drill bit.



Place the pieces **F1** in the holes in the ceiling.

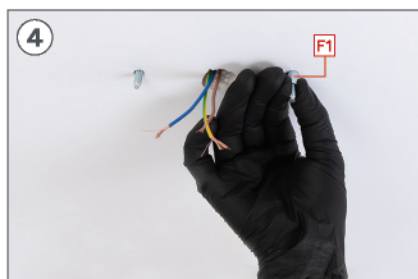

Only the part of the thread should protrude.



Place the part **K** matching its holes with the screws **F1**. Make sure the ceiling cables are to one side of the piece **K**.



Enter pieces **F2**, **F3** and then the nut **F4** in order.

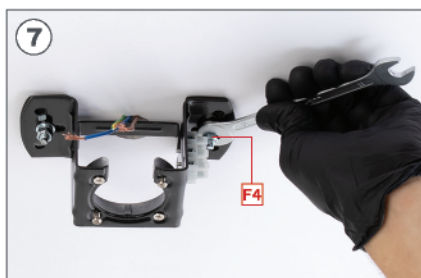

Tighten the piece **F4** with a # 10 wrench, until you feel it is tight.

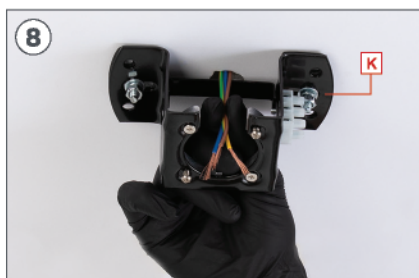

Make sure the piece **K** is perfectly hooked to the ceiling and that no cables are trapped.

# STEP 1. FALSE CEILING

## PARTS AND TOOLS

**K**



+



FIXING SCREWS  
WITH SPRING LEVER

+



+



MATERIAL NOT INCLUDED



Mark the 2 central holes on the ceiling with a pencil using the piece **K** as a guide.

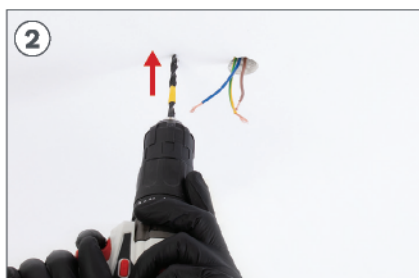

With the help of a drill, make the two corresponding holes.



Insert the fixing screws into the holes and make sure the lever opens.



Place the piece **K** and screw the fixing screws to the false ceiling.

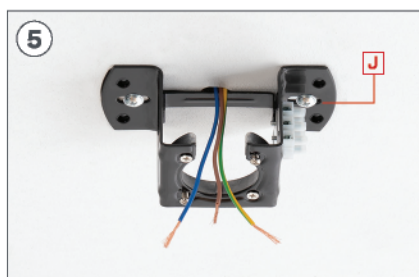

Make sure the piece **K** is perfectly attached to the ceiling and that no cables are trapped.

## CHOICE OF HEIGHT

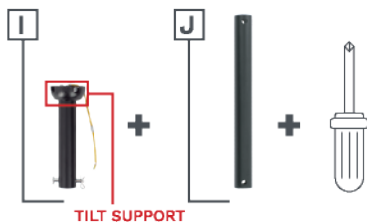

**Before you start, choose the desired height.**  
(10cm +/-)

You will have to choose between the height of pieces H or I.

- If you choose the height of piece I, you should follow the instructions below.

- If you choose the height of piece H, go directly to step 2 (page 11).

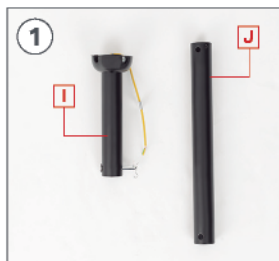

With the help of a screwdriver, remove the two screws from the tilt bracket of the bar I.



Slide the tilt bracket down.



Remove the pin from the tilt bracket.



Remove the tilt support from the bar I.



Remove the locking piece from the pin of bar I.



Carefully pull the pin out of the bar I.



Attach the tilt support to the bar J.



Place the tilt support pin into the bar J.



Fit the tilt bracket onto the pin.

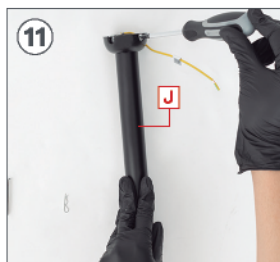

Tighten the two screws on the tilt bracket with the screwdriver.



Put the pin back in the the piece J.



Secure the pin with the locking piece so that it does not come out.



The piece J is ready to use.

## STEP 2. MAIN BODY ASSEMBLY



Remove pin from piece I or J, according to the chosen height.



Enter the bar I or J, depending on the chosen height, through the hole in the piece A.







Insert the piece **D** as shown in the picture.



Once the pieces **A** and **D** are inserted you must insert the cables of the piece **G** inside the bar. If you want, you can tape the wires down to make it easier to route them inside the bar.



With the help of a screw-driver, remove the 2 screws from the top of the piece **G**.



Insert the bar at the top of the piece **G**.



Make sure no wires are pinched.



Once the bar is inserted, place the pin of the piece **H/I** so that it matches the hole in the bar.



Place the locking piece on the pin so that it does not come off.



Then replace the two screws so that the bar is fully supported.



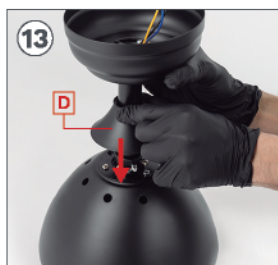

Once the bar is well anchored to the piece **G**, slide piece **D** down. The main frame of the fan motor will remain assembled.

## STEP 3. GROUND CONNECTION

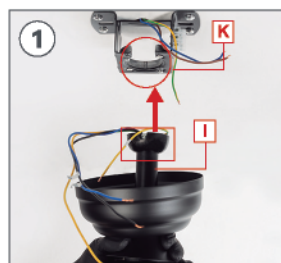

Place the tilt bracket into the slot on the piece **K** so that it is attached to the ceiling. Remember to put the notch on the black top back so that the piece fits well. Before continuing, check that the center frame is properly positioned so that it does not fall.

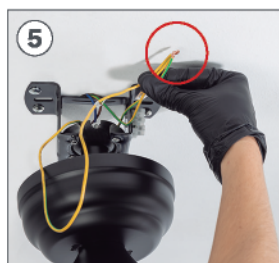
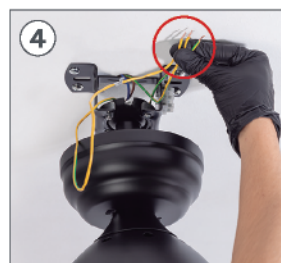

Connect the ground wire of piece **I** to that of the motor. In addition, if your electrical installation consists of your own grounding cable, also connect it to the cables of the piece **I** and the engine.

Once connected, place the piece **P** screwing it in until it is well attached.

## STEP 4. DRIVER CONNECTION

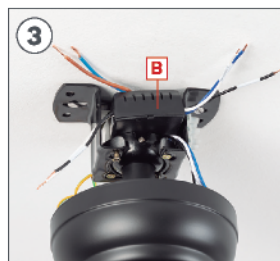

Insert the piece **B** in the groove of piece **K**. Check that all cables are correctly routed without getting caught.

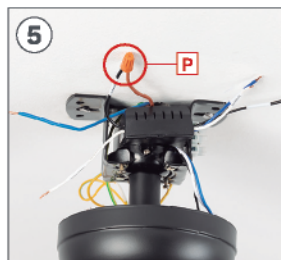

Connect the PHASE (L) cable of your installation to the PHASE cable of the piece **B**. Once connected, place the piece **P** screwing it in until it is well attached.

Connect the NEUTRAL wire (N) of your installation to the NEUTRAL wire of the piece **B** and place the piece **P** until it is securely attached.

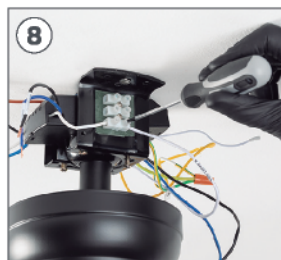

With the help of a flat screwdriver, connect the remaining wires of the piece **B** to those of the fan, joining each one with the strip and its respective cable.



Once the cables are connected, slide the piece **A** up to fit the screws protruding from the piece **K**. Once they are fitted, turn the piece **A** to the right.



Finally, with the help of a screwdriver, tighten the screws so that the piece **A** is securely attached to the ceiling.

## STEP 5. ASSEMBLING THE BLADES

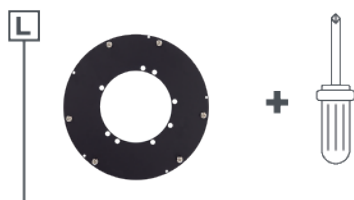

Remove all screws from the piece **L**.



Place a blade on piece **L** matching the holes.



Install 2 screws as shown in the picture without overtightening them.



Repeat steps 2 and 3 with the two remaining blades.



Tighten the screws until you feel that the blades are properly attached.



Make sure the blades are properly attached.



With the help of a screwdriver, remove the 5 screws from the lower part of the main body that is mounted on the ceiling, to be able to place the blades. Save the screws, you will need them later.



Carefully position the blades by matching up the screw holes you removed in the previous step.



Carefully place the screws you removed from the main body into the holes that match the holes in piece K As shown in the picture.



Make sure the blades are perfectly attached.

## STEP 6. DECORATIVE ELEMENT PLACEMENT



With the help of a screwdriver, remove the 3 central screws **O** from the lower part of the motor.

Pass the cables through the center hole of the piece **H**.



Place the piece **H** to match the screw holes.

Replace the 3 central screws **O** screwing them so that the piece **H** is securely attached.



## OPTION WITH LED KIT

### STEP 7. LED PLATE CONNECTION



Connect the wires on piece **M** to those of the fan joining the connections, each wire with the same color.



Then attach the piece **M** to the piece **H** with the help of the magnets to hold it.

## STEP 8. LAMP COVER PLACEMENT

N



LAMP COVER



Place the piece **N** on the fan by fitting it into the motor and fix it by turning clockwise. Do not forget to check that the piece **N** fits well. Once verified, you will be able to connect the electricity and enjoy your new fan with light.



## OPTION WITHOUT LED KIT

### STEP 7. ATTACHING THE DECORATIVE COVER

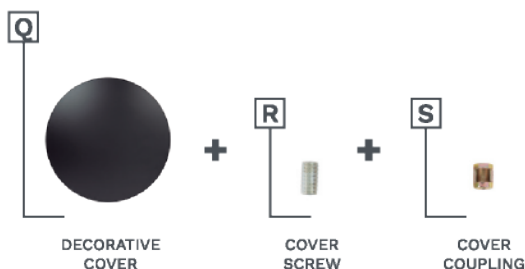

Carefully insert the fan cables inside the piece **S** and take them out through the large side hole of the piece. Then screw the piece **S** and check that it remains securely attached to the fan.



Take the piece **Q** and tighten the screw **R** into the hole so that it is securely attached.





Place the piece **Q** inserting the screw into the hole in the fan body. Screw the piece **Q** until it is securely attached. Later, you can connect the electricity and enjoy your new fan.



## BLADE BALANCING KIT

U

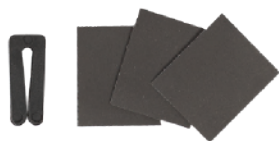

Your ceiling fan may have blade swing problems when in operation due to irregularities in the blades or brackets. Also, incorrect system mounting or crooked bearings could cause additional problems. The following procedure is recommended to remedy these problems:

1. Make sure the blades are firmly screwed to their brackets.
2. Make sure that all blades are firmly secured to the center swivel casing and check the inclination of the blade holders, they should all be the same.
3. Standing under the fan and looking up, check that none of the blade supports are bent so that none of the blades are misplaced. You can correct the position of the blade holders by gently bending them to the correct position.
4. You can check the height of the blades with a simple school ruler. Place the ruler against the ceiling vertically and level with the outside of the blade tip. Check the distance from the blade tip to the ceiling, carefully rotate the blades by hand and check the rest of the blades. If the blades are not aligned, you can carefully bend the blade holder up or down slightly to align with each other.

If the balance problem is not solved even by following the steps above, you must perform a dynamic balancing using the kit provided. Follow the procedure below:

1. Turn on the fan and set the speed at which the greatest sway is created (usually occurs at the highest speed).
2. Turn off the fan. Select a blade and place the balancing clip, midway between the bracket and the tip, on the rear edge of the blade.
3. Turn on the fan. Wait to see if the sway has improved or worsened. Turn off the fan again and attach the clip to another blade to retest. Repeat this process with all the blades and check which one has improved the most.
4. Place the clip on the blade that has improved the most. Move it in or out of the blade and run the fan to find the best position where the clip offers the greatest roll improvement.
5. Then remove the clip and install a balancing weight on top of the blade on the center line near the point where the clip was placed. Use a knife or blade if necessary to separate the weights.

**Caution:** Stand at a safe distance from the blades. If the clip has not been properly secured, for any reason, you could be injured.

[illegible]

**CREATE**