

CREATE

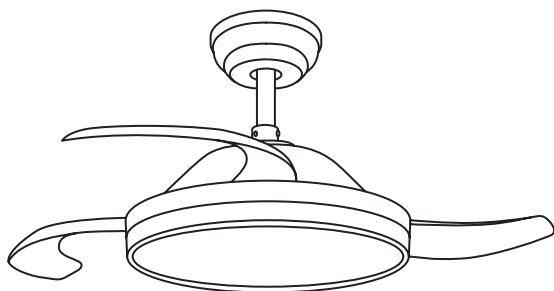
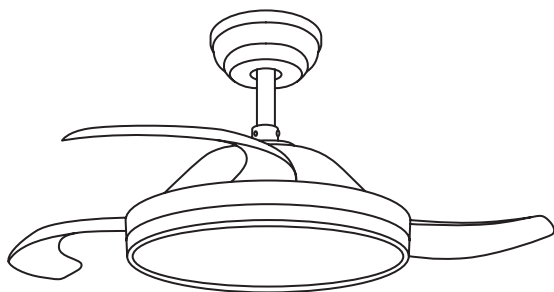
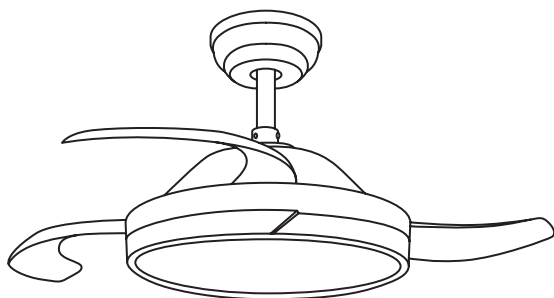

Wind Clear

Manual assembly

CREATE



EN

To download this user guide in your language, visit our website:
www.create-store.com/uk/



ES

Para descargar el manual en su idioma, visite nuestra web:
www.create-store.com/es/



PT

Para baixar o manual no seu idiomas, visite nosso site:
www.create-store.com/pt/



FR

Pour télécharger le manuel dans votre langue, visitez notre site Web:
www.create-store.com/fr/



IT

Per scaricare il manuale nella sua lingua, visitare il nostro sito Web:
www.create-store.com/it/



DE

Um das Handbuch in Ihrer Sprachen herunterzuladen, besuchen Sie unsere Website:
www.create-store.com/de/



NL

Bezoek onze website om de handleiding in uw taal te downloaden:
www.create-store.com/nl/



PL

Aby pobrać instrukcję w swoim języku, odwiedź naszą stronę internetową:
www.create-store.com/pl/

THIS MANUAL IS FOR ALL MODELS WIND CLEAR



INDEX

Box contents	4
Step 1. Wood roof	5
Step 1. Concrete ceiling	6
Step 1. False ceiling	8
Choice of grab bar	9
Step 2. Main body assembly	11
Step 3. Driver connection	13
Step 4. Assembly of the trim	16
Step 5. Led board connection	17
Step 7. Assembly of the shade	18
Blade balancing kit	19

BOX CONTENTS



ATTENTION! Before starting the assembly, remember to disconnect the light from the electrical box to avoid suffering an electric shock.

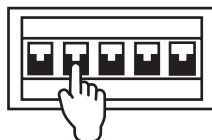

STEP 1. WOOD ROOF

PARTS AND TOOLS

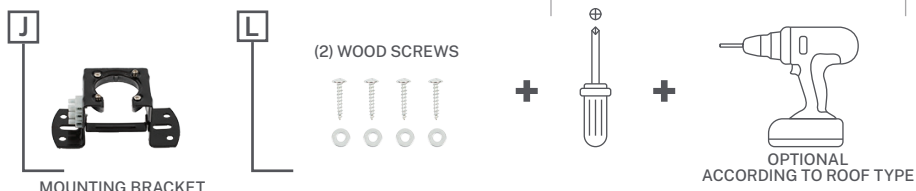

Mark with a pencil the 4 holes of the piece J in the roof.



If necessary, depending on the type of roof, you will need to use a drill to make the hole in the wood.

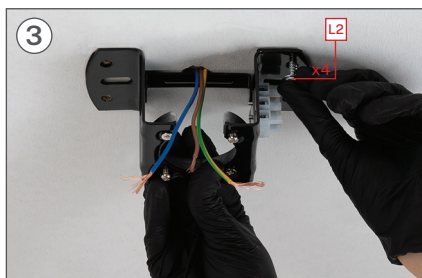

Place the washer and then the screw L2.

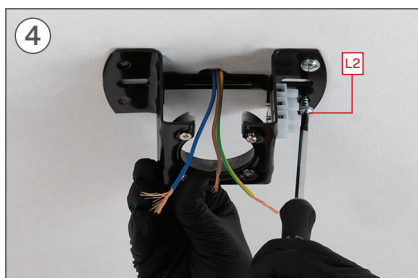

With the help of the screwdriver tighten the screws L2.

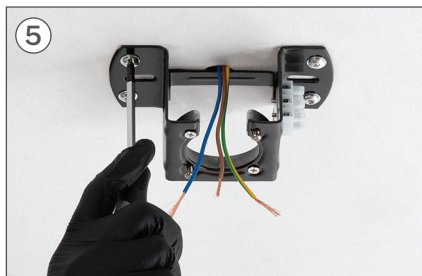

Repeat this step for the remaining 3 holes.

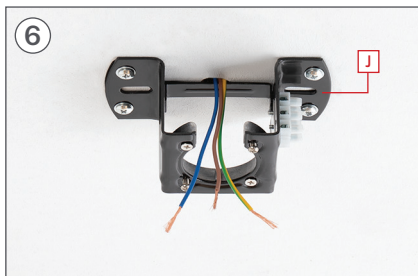

Make sure the part J is perfectly attached to the ceiling and no cable is trapped.

STEP 1. CONCRETE CEILING

PARTS AND TOOLS

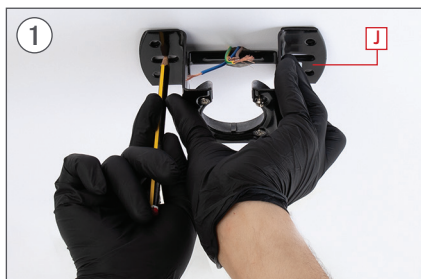
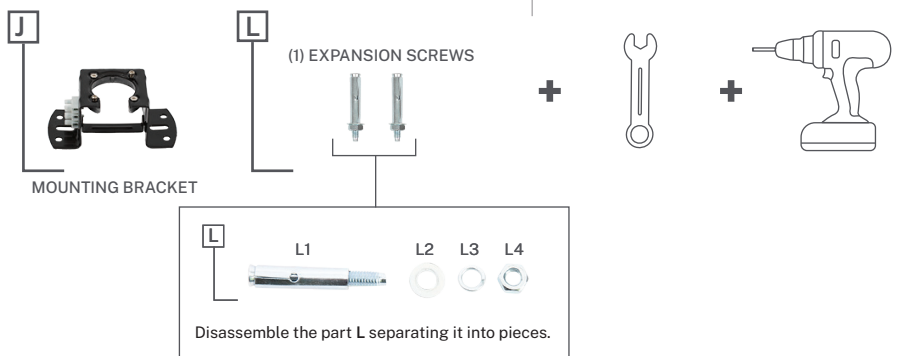

Mark with a pencil the 2 central holes of the piece J on the ceiling using the same piece as a guide.



With the help of a drill, make the two corresponding holes with a Ø8 mm bit.

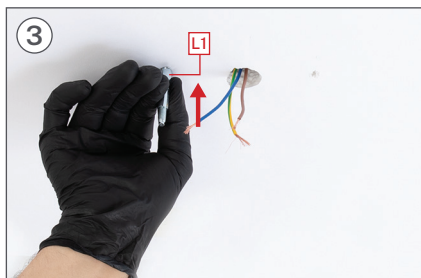

Place the pieces L1 in the holes in the ceiling.

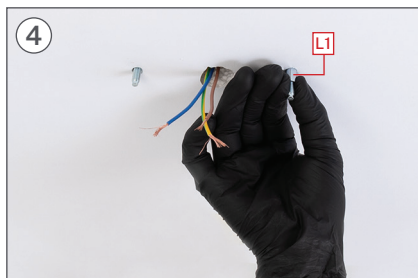

Only the part of the thread should protrude.

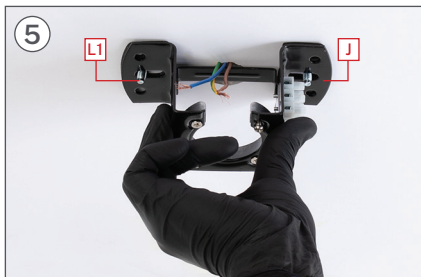

Place the piece J matching their holes with the screws L1. Make sure the ceiling cables are on one side of the piece J.



Introduce the part in order L2, L3 and then the nut L4.

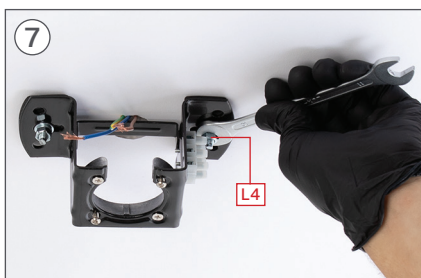

Tighten the part L4 with a no. 10 spanner, until you feel it is secure.

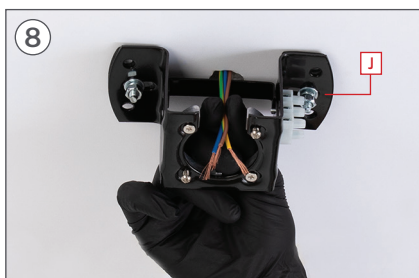

Make sure the part J it is perfectly attached to the ceiling and no cable is trapped.

STEP 1. FALSE CEILING

PARTS AND TOOLS

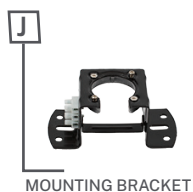

EQUIPMENT NOT INCLUDED

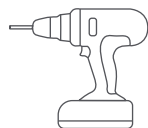

Mark on the ceiling with a pencil the 2 central holes of the piece J using the same piece as a guide.

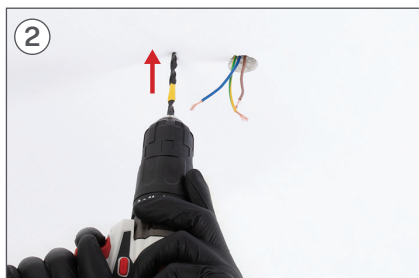

With the help of a drill, make the 2 corresponding holes.



Insert the set screws into the holes and make sure the lever opens.

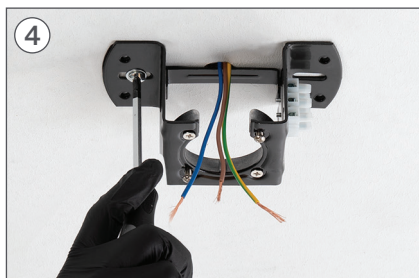

place the piece J and screw the fixing screws to the false ceiling.

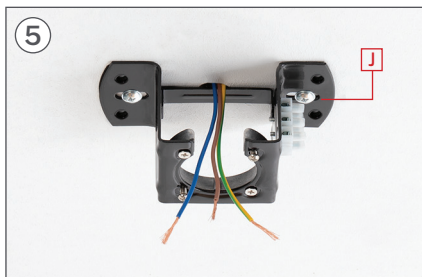

Make sure the part J is perfectly attached to the ceiling to continue with the assembly.

CHOICE OF GRAB BAR

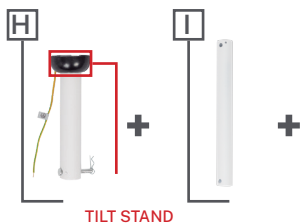

Before you start, choose the desired height.
(10cm +/-)

You must choose between the height of the piece **h** wave **YO**.

- If you choose the height of the piece **YO**, you should follow the instructions below.
- If you choose the height of the piece **h**, go directly to step 2 (page 13).

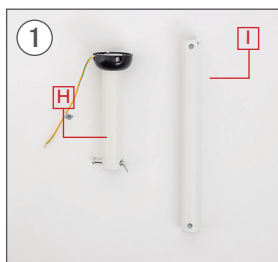

With the help of a screwdriver, remove the two screws from the tilt bar bracket **h**.



Slide the tilt stand down.



Remove the tilt bracket pin.



Remove the support from bar tilt **h**.



Remove the locking piece from the bar pin **h**.

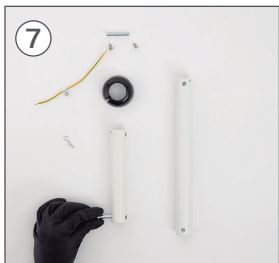

Carefully remove the pin from the bar H.

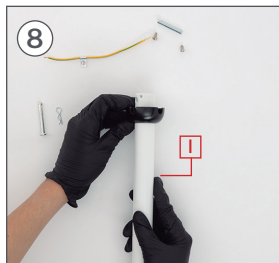

Attach the tilt bracket to the bar I.



Place the tilt bracket pin on the bar I.



Snap the tilt bracket onto the pin.

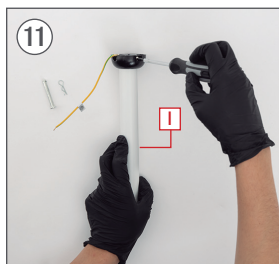

Tighten the two tilt bracket screws with the screwdriver.



Put the pin back in the piece I.



Secure the pin with the locking piece so that it does not come out.

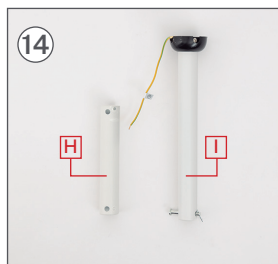

The piece is there I ready to use.

STEP 2. MAIN BODY ASSEMBLY

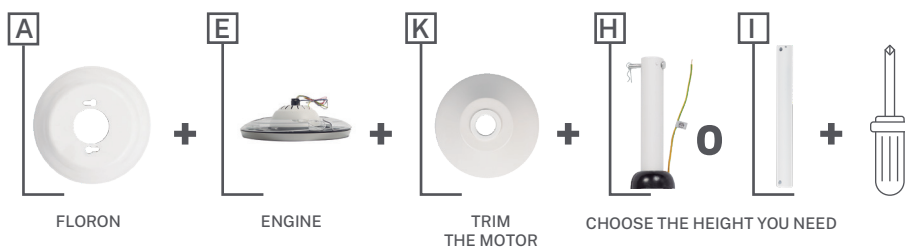

Remove the pin from the part H/I, according to the chosen height.



Insert the stem H/I, through the hole of the piece A.



Insert the piece K on the stem H/I As shown in the picture.

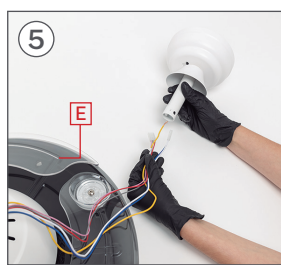

Once the pieces are inserted A and K, you must insert the wires of the part E inside the stem. If you want, you can tape the wires together to make it more Easy to get them inside.



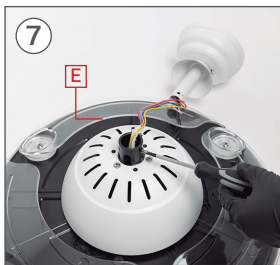

With the help of a screwdriver, remove the 2 screws from the top of the piece E.



Insert the stem into the upper part of the piece E.



Make sure no wires are pinched.



Once inserted, place the blocking piece of the seat-post H/I so that it coincides with the hole in the bar.



Place the pin in the lock piece so it won't come out.

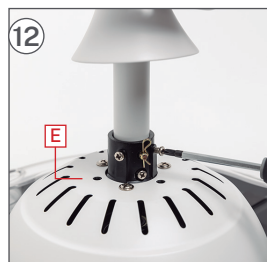

Then replace the two screws so that the seat post is fully attached.



Once the stem is well anchored to the piece E, slide piece K down. The main structure of the fan motor will be assembled.

STEP 3. DRIVER CONNECTION

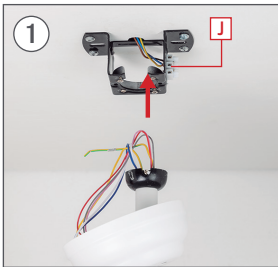
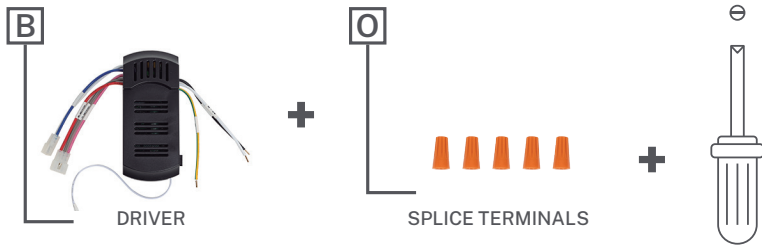

Place the tilt support in the groove of the workpiece J.

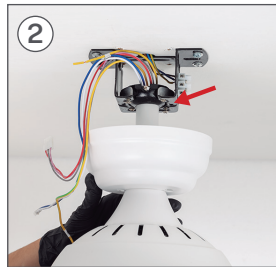

Remember to position the notch on the tilt bracket to the rear so the part will fit correctly.

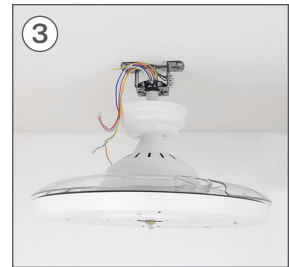

Before proceeding, check that the central structure is securely positioned so that it does not fall.



Join the connections of the part B. with the connections of the Engine, each with its corresponding color.

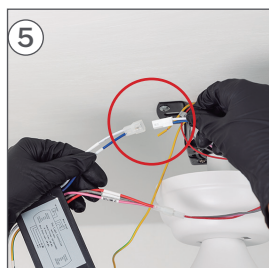

Once the cables are connected, insert the part B. inside the piece J. As shown in the picture.



Select and connect the ground wires of the controller and your house.

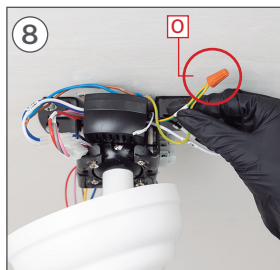

Once connected, place the piece **O** screwing it in until it is secure.

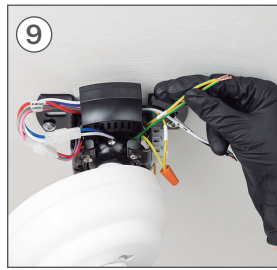

Select and connect the motor and seat post ground wires.



Once connected, place the piece **O** screwing it in until it is secure.



You will need to join the remaining wires of the part **B** and the phase and neutral cables of your installation in the terminal of part **J**, as shown below.

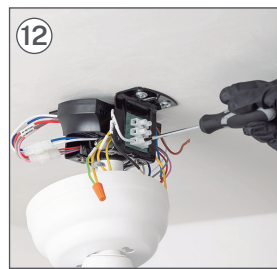

Connect the wire **L** of the driver to the **PHASE** cable of your installation.

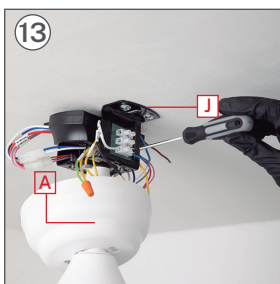

Connect the wire **N** of the driver to the **NEUTRAL** cable of your installation.



Make sure there are no pinched wires.



Slide piece **A** upwards.



Fit it into the screws that protrude from the piece J.



Once fitted, turn the piece A toward the left. Make sure that no wires are pinched.



With the help of a screwdriver, tighten the screws on the left side.



Finally, with the help of a screwdriver, tighten the screws on the right side.



Check that the part is well fixed.

STEP 4. ASSEMBLY OF THE TRIM

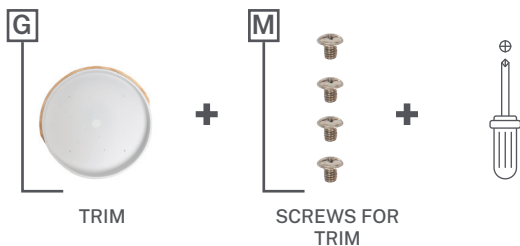

Using a screwdriver, remove the 4 screws from the center of the fan body for later use. If these screws come in a sealed bag, use them for this step.



Place the piece G. aligning the holes with the holes in the motor.



Leave the blue and white wires exiting through the center hole of the trim



Tighten the screws used in step 1.

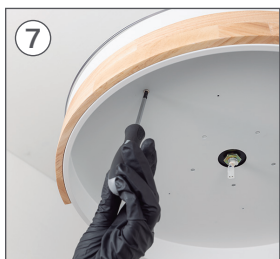

When finished, make sure that the part G. is properly attached.

STEP 5. LED BOARD CONNECTION

D



LED PLATE

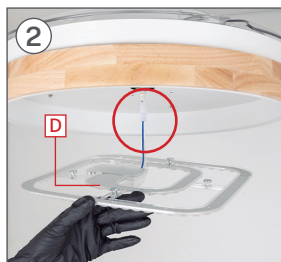

Connect the wires of the part D. to those of the fan joining the connections.

The piece D. It is equipped with magnets to facilitate its assembly.

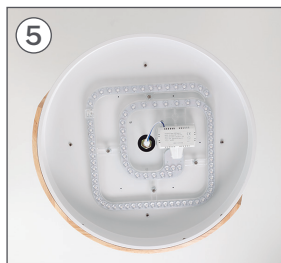

Then attach the part D. to the fan with the help of magnets to hold it.

STEP 7. ASSEMBLY OF THE SHADE

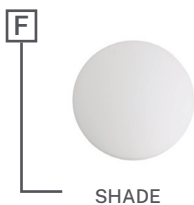

Place the piece **F** bending it slightly to fit it into the body of the fan. Once you have verified that the piece is securely fastened, you can connect the electricity and enjoy your new fan with light.

BLADE BALANCING KIT

Q

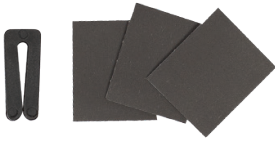

Your ceiling fan may have blade swinging issues when it is running due to irregularities in the blades or brackets. Also, incorrect mounting of the system or crooked bearings could cause additional problems. The following procedure is recommended to remedy these problems:

1. Make sure the blades are firmly bolted to their brackets.
2. Make sure all blades are securely attached to the center swivel housing and check the pitch of the blade holders, they should all be the same.
3. Standing under the fan and looking up, check that none of the blade brackets are bent so that none of the blades are misplaced. You can correct the position of the blade holders by gently bending them into the correct position.
4. You can check the height of the blades with a simple school ruler. Place the ruler against the ceiling vertically and level with the outside of the blade tip. Check the distance from the tip of the blade to the ceiling, rotate the blades carefully by hand and check the rest of the blades. If the blades are not aligned, you can carefully bend the blade bracket up or down slightly to align with each other.

If the balance problem is not resolved even by following the steps above, you should perform dynamic balancing using the provided kit. Follow the procedure below:

1. Turn on the fan and adjust the speed at which the most rocking is created (normally occurs at the highest speed).
2. Turn off the fan. Select a blade and place the balance clip, halfway between the bracket and the tip, on the trailing edge of the blade.
3. Turn on the fan. Wait to see if the sway has improved or worsened. Turn the fan off again and place the clip on another blade to recheck. Repeat this process with all the blades and see which one has improved the most.
4. Place the clip on the blade that has improved the most. Move it in or out of the blade and crank the fan to find the best position where the clip offers the most balance improvement.
5. Then remove the clip and install a balance weight on top of the blade on the centerline near the point where the clip was attached. Use a knife or blade if necessary to separate the weights.

Careful: Stand at a safe distance from the blades. If the clip has not been secured correctly, for whatever reason, you could be injured.

[illegible]

[illegible]

CREATE