

# CREATE

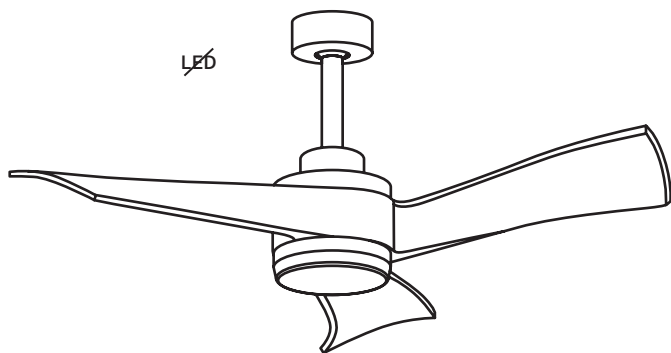
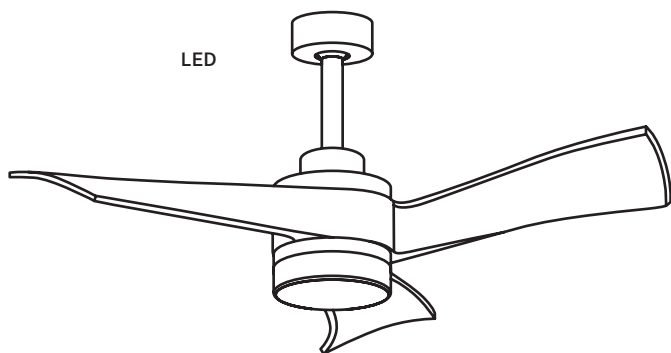

## Wind Curve

---

Assembly manual

[illegible]

[illegible]

# CREATE



## EN

To download this user guide in your language, visit our website:  
[www.create-store.com/uk](http://www.create-store.com/uk)



## ES

Para descargar el manual en su idioma, visite nuestra web:  
[www.create-store.com/es](http://www.create-store.com/es)



## PT

Para baixar o manual no seu idiomas, visite nosso site:  
[www.create-store.com/pt](http://www.create-store.com/pt)



## FR

Pour télécharger le manuel dans votre langue, visitez notre site Web:  
[www.create-store.com/fr](http://www.create-store.com/fr)



## IT

Per scaricare il manuale nella sua lingua, visitare il nostro sito Web:  
[www.create-store.com/it](http://www.create-store.com/it)



## DE

Um das Handbuch in Ihrer Sprachen herunterzuladen, besuchen Sie unsere Website:  
[www.create-store.com/de](http://www.create-store.com/de)



## NL

Bezoek onze website om de handleiding in uw taal te downloaden:  
[www.create-store.com/nl](http://www.create-store.com/nl)



## PL

Aby pobrać instrukcję w swoim języku, odwiedź naszą stronę internetową:  
[www.create-store.com/pl](http://www.create-store.com/pl)



## THIS MANUAL IS FOR WIND CURVE MODELS

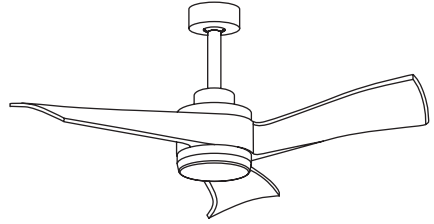
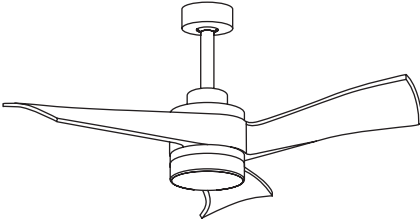

## INDEX

---

Box content	6
Step 1. Wood ceiling	7
Step 1. Concrete ceiling	8
Step 1. False ceiling	10
Choice of height	11
Step 2. Main body assembly	12
Step 3. Driver connection	14
Step 4. Assembling the blades	16
Step 5. Placing the decorative element	17
OPTION WITH LED KIT	18
Step 6. Led plate connection	18
Step 7. Lamp cover placement	19
OPTION WITHOUT LED KIT	20
Step 6. Fitting the decorative cover	20
Blade balancing kit	22

# BOX CONTENT

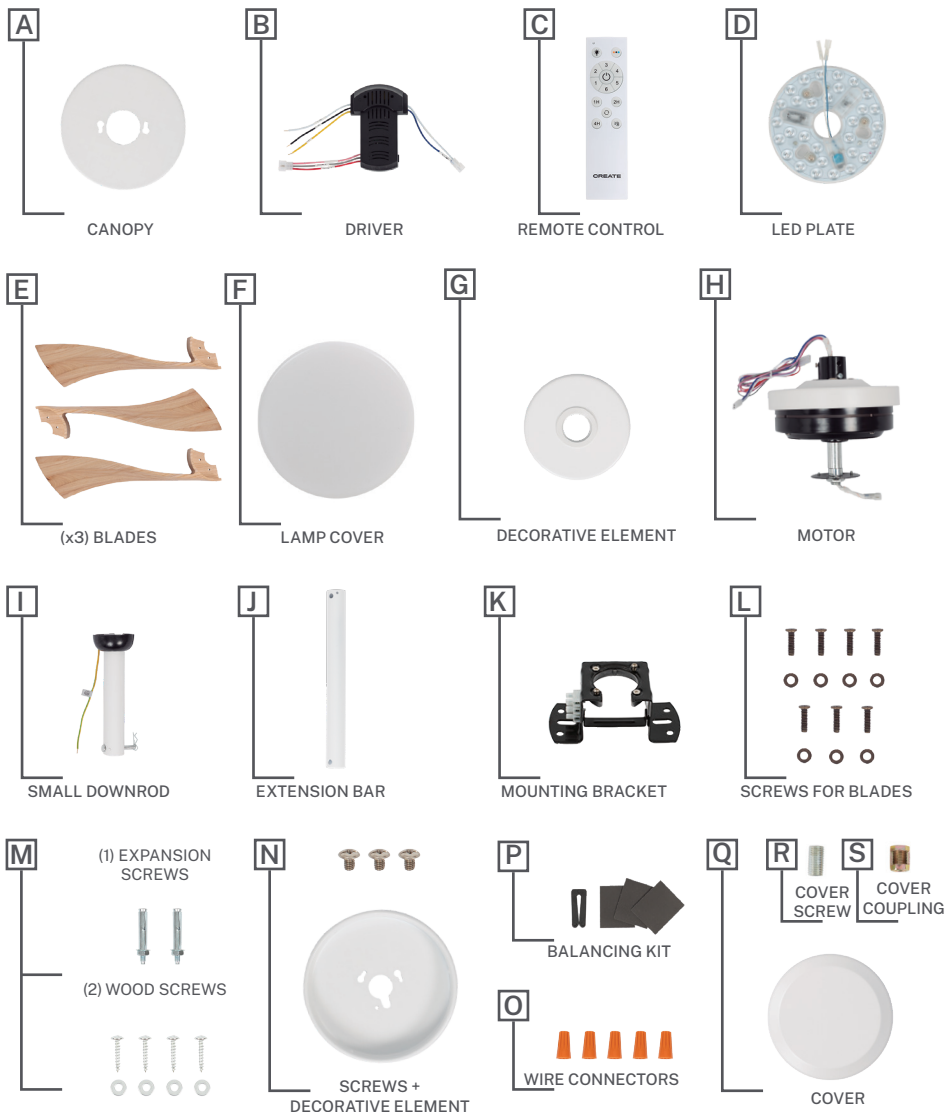

**ATTENTION!** Before starting the assembly, remember to disconnect the light from the electrical panel so as not to suffer an electric shock.

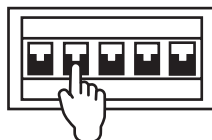

# STEP 1. WOOD CEILING

## PARTS AND TOOLS

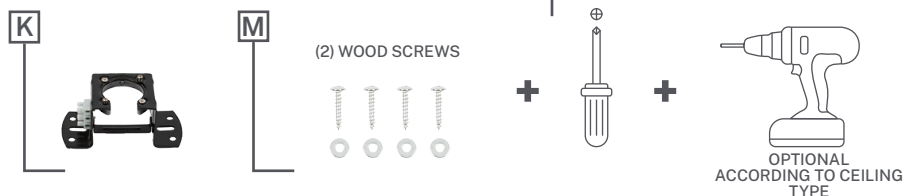

Mark on the ceiling with a pencil the 4 holes of piece K.



If necessary, depending on the type of ceiling, you will need to use a drill to make the hole in the wood.

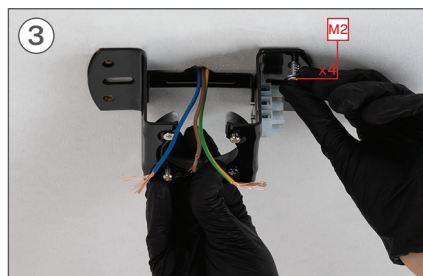

Place the washer and then the screw M2.

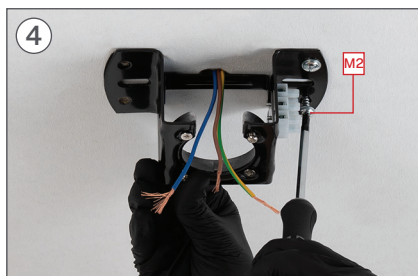

Using the screwdriver, tighten the screw M2.

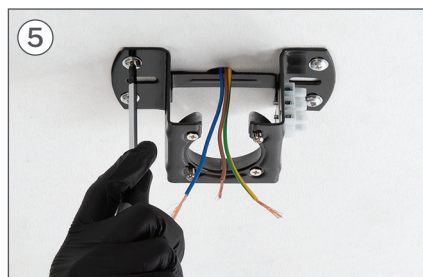

Repeat the previous step for the remaining holes.

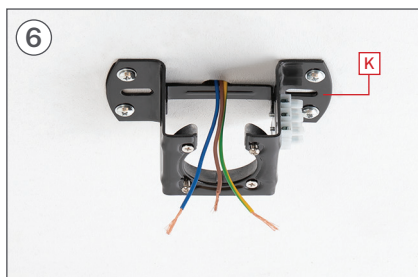

Make sure that part K is perfectly fixed to the ceiling and that no wires are trapped.

# STEP 1. CONCRETE CEILING

## PARTS AND TOOLS

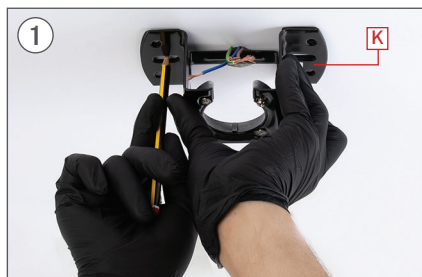
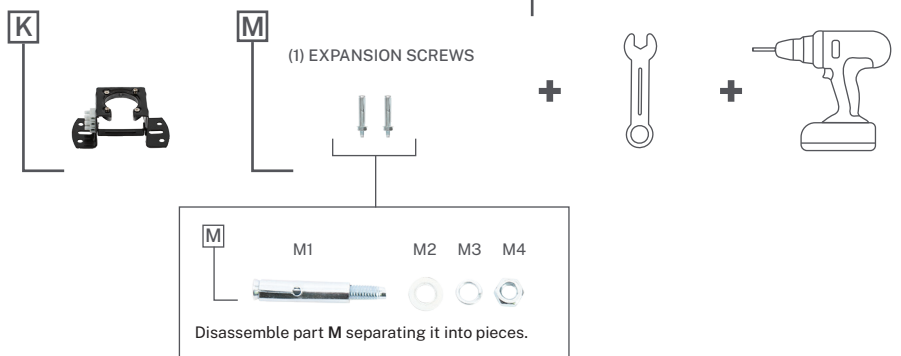

Mark on the ceiling with a pencil the 2 central holes of piece K, using the same piece as a guide.



With the help of a drill, make the two corresponding holes with an Ø8 mm drill bit.

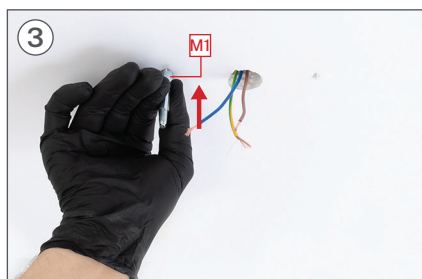

Place the pieces M1 in the holes on the ceiling.



Only the thread of the screw should stick out.

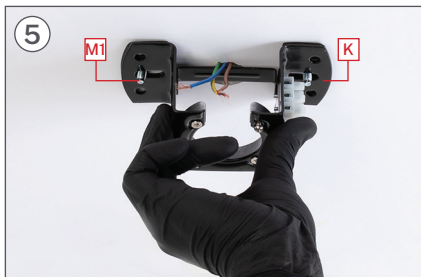

Place part **K** matching its holes with the screws **M1**. Make sure the ceiling wires are placed on one side of piece **K**.



Insert pieces **M2**, **M3** and subsequently the nut **M4**.

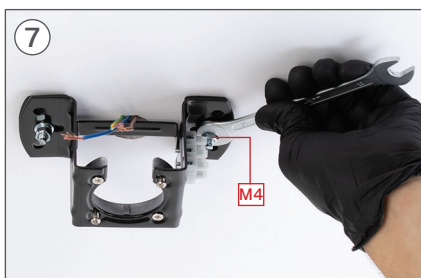

Tighten piece **M4** with a # 10 wrench, until you feel that it is well fixed.

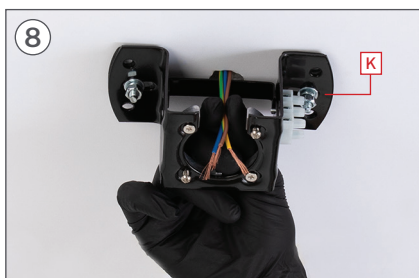

Make sure that piece **K** is perfectly hooked to the ceiling and that no wires are trapped.

# STEP 1. FALSE CEILING

## PARTS AND TOOLS



Mark on the ceiling with a pencil the 2 central holes using piece K as a guide.

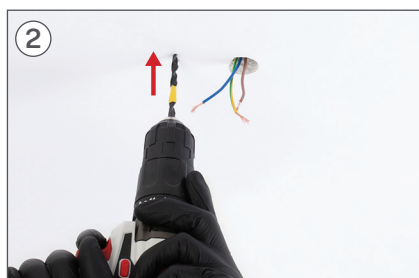

With the help of a drill, make the two corresponding holes.



Insert the fixing screws into the holes and make sure the lever opens.

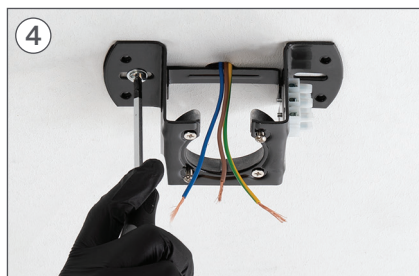

Place piece K and screw the fixing screws to the false ceiling.

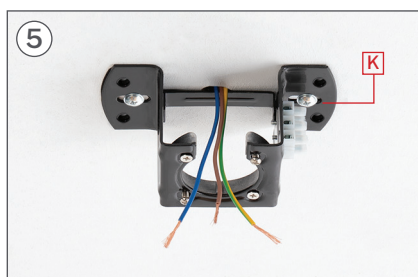

Make sure that part K is perfectly attached to the ceiling to continue with the assembly.

## CHOICE OF HEIGHT

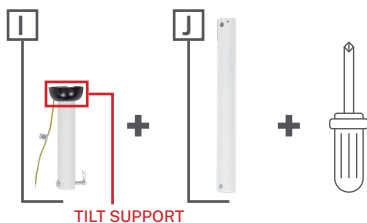

**Before you start, choose the desired height.**  
(10cm +/-)

You will have to choose between the height of piece I or piece J.

- If you choose the height of piece J, you should follow the instructions below.

- If you choose the height of piece I, go directly to step 2 (page 12).

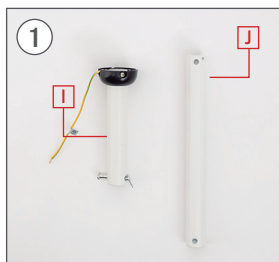

Using a screwdriver, remove the two screws from the tilt support of bar I.



Slide the tilt support down.



Remove the pin from the tilt support.



Remove the tilt support from the bar I.



Remove the locking piece from the bar I pin.



Gently pull the pin out of bar I.



Attach the tilt support to bar J.



Place the tilt support pin into bar J.





Fit the tilt support onto the pin.

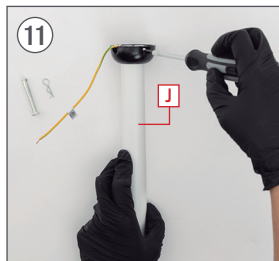

Tighten the two screws on the tilt support with the screwdriver.



Put the pin back into part J.

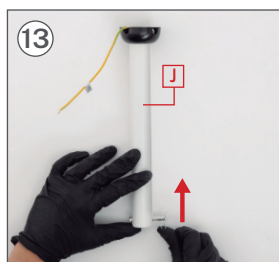

Secure the pin with the locking piece so that it does not come out.

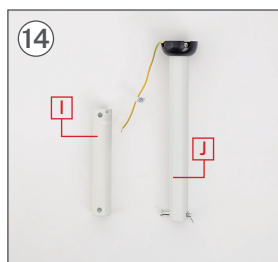

Piece J will be ready to be used.

## STEP 2. MAIN BODY ASSEMBLY

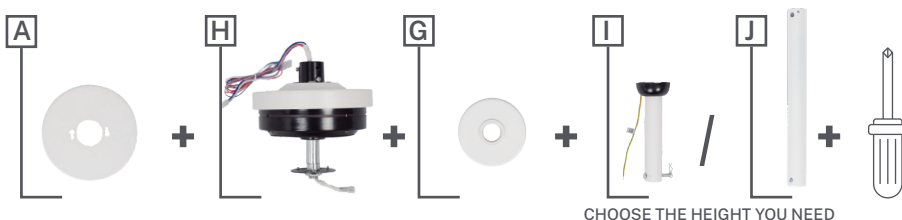

Remove the pin from part I or J, according to the chosen height.



Insert the chosen bar through the hole in part A.

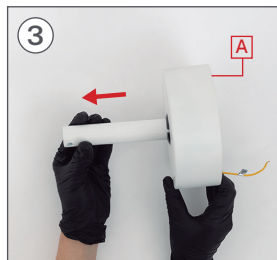



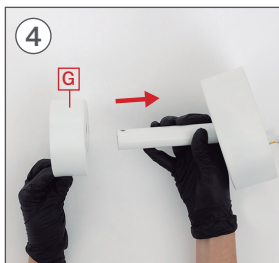

Insert part **G** as shown in the picture.



Once the pieces **A** and **G** are inserted, you must insert the wires of part **H** inside the bar. If you want, you can tape the wires down to make it easier to run them inside the bar.

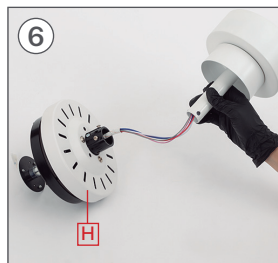

With the help of a screwdriver, remove the 2 screws at the top of piece **H**.



Insert the bar at the top of piece **H**.

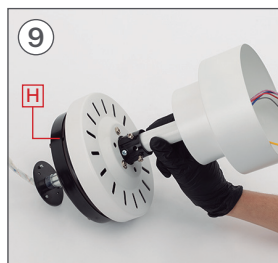

Make sure no wires are pinched.



Once the bar is inserted, place the pin of piece **I/J** so that it matches the hole in the bar.



Place the locking piece on the pin so that it does not come off.



Then replace the two screws so that the bar is fully secured.

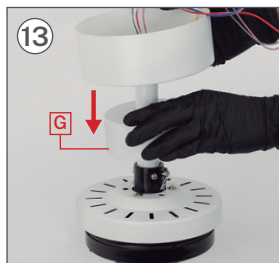

Once the bar is well anchored to piece H, slide piece G down. The main frame of the fan motor will remain assembled.

## STEP 3. DRIVER CONNECTION

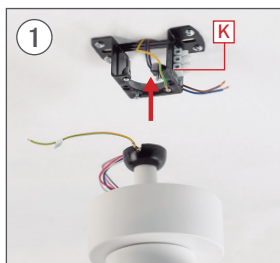
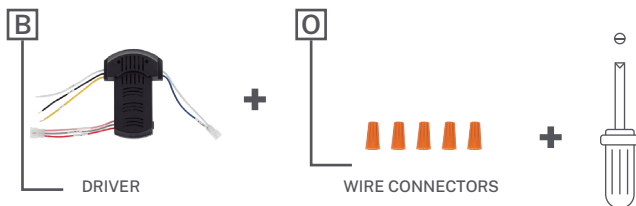

Place the tilt support in the slot of piece K.

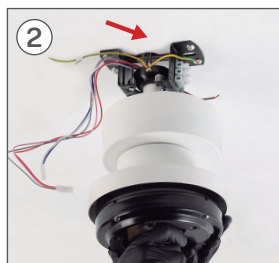

Remember to put the notch of the black top of the tilt support backwards so that the piece fits properly.

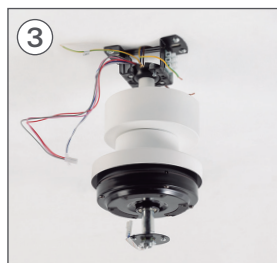

Before continuing, check that the center frame is securely positioned so that it does not fall.

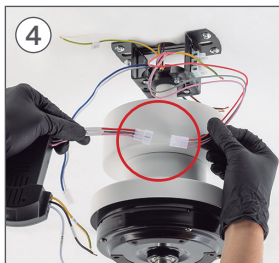

Join the connections in piece **B** to those in the motor, each with its corresponding color.



Once the wires are connected, insert piece **B** inside piece **K**, as shown in the image.



Select and connect all the grounding wires together, including the one from your own house wiring.



Once connected, place piece **O** screwing it until it is well tighten.



Then, you have to join the remaining wires of piece **B** and the line and neutral wires from your house wiring in the block terminal in piece **K**, as shown below.

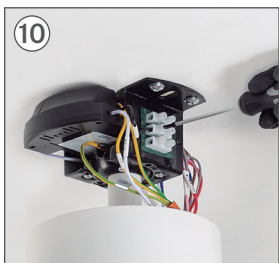

Connect the L wire from the driver with the LINE wire from your house wiring.

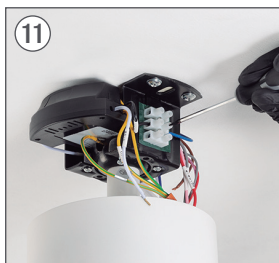

Connect the N wire from the driver with the neutral wire from your house wiring.



Make sure the wires aren't pinched.



Slide part A up to fit the screws protruding from piece K.



Once fitted, turn piece A to the right.



Finally, with the help of a screwdriver, tighten the screws so that the piece is well fixed.

## STEP 4. ASSEMBLING THE BLADES

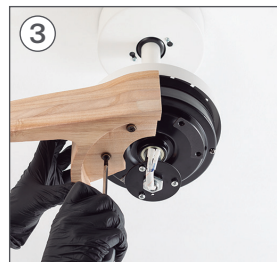
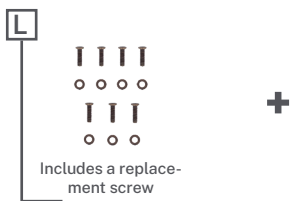

With the motor well positioned, we will begin the assembly of the blades E.

Place the first blade E securing it with the washers and screws L with the help of the screwdriver, without tightening them too much, to be able to put the rest of the blades.

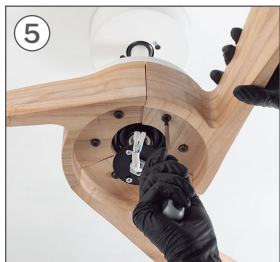
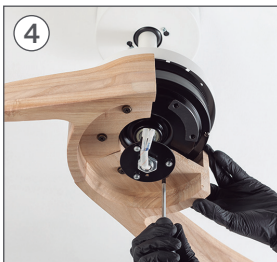

Follow the same step with the second and third blades **E**. Remember not to screw in the screws completely.

Once all the blades **E** are in place, screw all the screws **L** tightly so that the blades are well attached.

## STEP 5. PLACING THE DECORATIVE ELEMENT

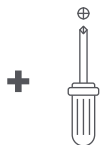
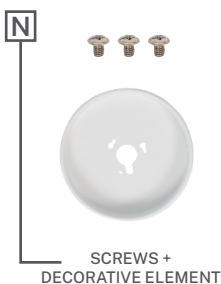

Using a screwdriver, remove the 3 center screws from the motor for later use.

Pass the motor wires through the center hole of piece **N**.





Place piece **N** aligning its holes with the holes in the motor.

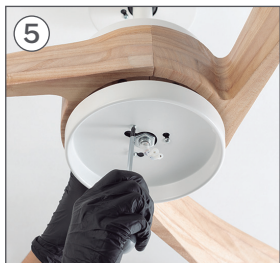

Firmly tighten the screws removed in step 1 so that piece **N** is properly attached.



## OPTION WITH LED KIT

### STEP 6. LED PLATE CONNECTION

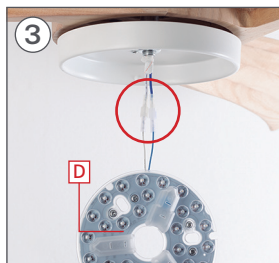
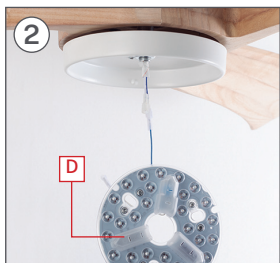
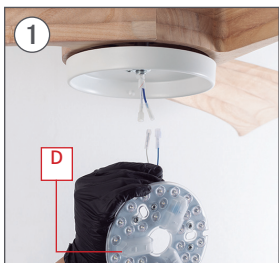
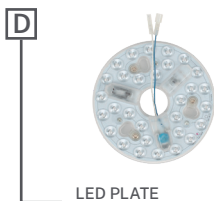

Connect the wires in piece **D** to those of the fan joining the connections, each wire with the same colour.



Then attach piece **D** to piece **N** with the help of the magnets to hold it.

## STEP 7. LAMP COVER PLACEMENT

F



LAMP COVER



Place piece F on the fan by fitting it into the motor and fix it by turning clockwise. Do not forget to check that piece F fits well. Once checked, you can connect the electricity and enjoy your new fan with light.



## OPTION WITHOUT LED KIT

### STEP 6. FITTING THE DECORATIVE COVER

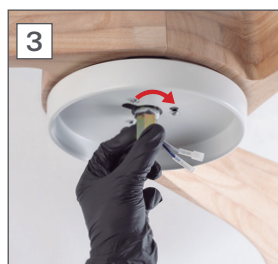
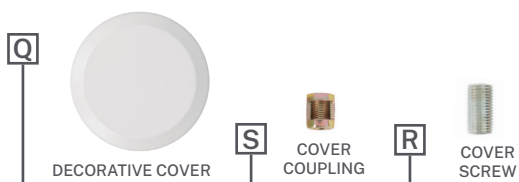

Carefully insert the fan wires inside piece S and take them out through the large side hole of this piece. Then screw piece S and check that it remains securely attached to the fan.

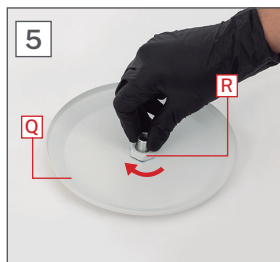
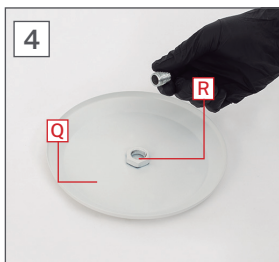

Take piece Q and tighten the screw R into the hole so that it is securely attached.





Then take the piece **Q** and tighten the screw **R** on the nut **S** previously placed on the fan. Once the piece is in place, you can connect the electricity and enjoy your new fan.



## BLADE BALANCING KIT



Your ceiling fan may have blade swing problems when in operation due to irregularities in the blades or brackets. Also, incorrect system mounting or crooked bearings could cause additional problems. The following procedure is recommended to remedy these problems:

1. Make sure the blades are firmly screwed to their brackets.
2. Make sure all blades are firmly secured to the center swivel casing and check the inclination of the blade mounts, they should all be the same.
3. Standing under the fan and looking up, check that none of the blade supports are bent so that none of the blades are misplaced. You can correct the position of the blade holders by gently bending them to the correct position.
4. You can check the height of the blades with a simple school ruler. Place the ruler against the ceiling vertically and level with the outside of the blade tip. Check the distance from the blade tip to the ceiling, carefully rotate the blades by hand and check the rest of the blades. If the blades are not aligned, you can carefully bend the blade holder up or down slightly to align with each other.

If the balance problem is not solved even by following the steps above, you must perform a dynamic balance using the kit provided. Follow the procedure below:

1. Turn on the fan and set the speed at which the greatest sway is created (usually occurs at the highest speed).
2. Turn off the fan. Select a blade and place the balancing clip, midway between the bracket and the tip, on the rear edge of the blade.
3. Turn on the fan. Wait to see if the sway has improved or worsened. Turn the fan off again and attach the clip to another blade to retest. Repeat this process with all the blades and check which one has improved the most.
4. Place the clip on the blade that has improved the most. Move it in or out of the blade and run the fan to find the best position where the clip offers the greatest roll improvement.
5. Then remove the clip and install a balancing weight on top of the blade on the center line near the point where the clip was placed. Use a knife or blade if necessary to separate the weights.

**Watch out:** Stand at a safe distance from the blades. If the clip has not been properly secured, for any reason, you could be injured.

[illegible]

**CREATE**