

CREATE

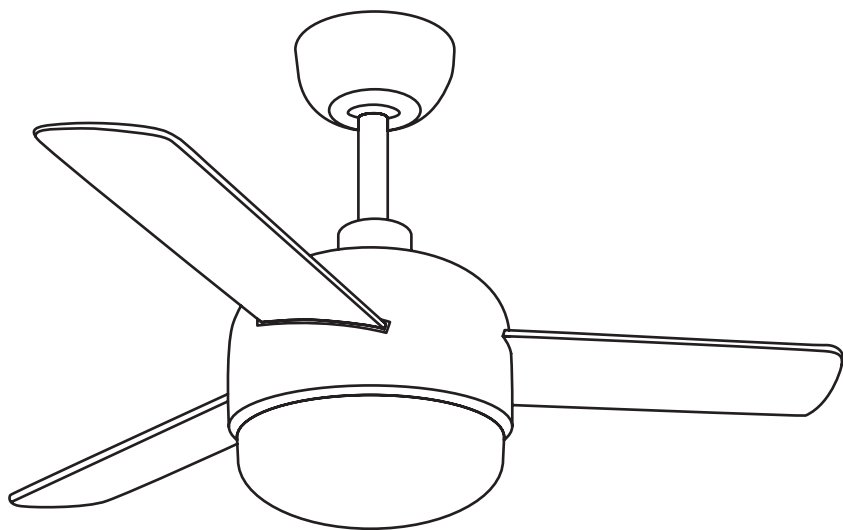

Wind Ball

Assembly manual

[illegible]

[illegible]

CREATE



EN

To download this user guide in your language, visit our website:
www.create-store.com/uk



ES

Para descargar el manual en su idioma, visite nuestra web:
www.create-store.com/es



PT

Para baixar o manual no seu idiomas, visite nosso site:
www.create-store.com/pt



FR

Pour télécharger le manuel dans votre langue, visitez notre site Web:
www.create-store.com/fr



IT

Per scaricare il manuale nella sua lingua, visitare il nostro sito Web:
www.create-store.com/it



DE

Um das Handbuch in Ihrer Sprachen herunterzuladen, besuchen Sie unsere Website:
www.create-store.com/de



NL

Bezoek onze website om de handleiding in uw taal te downloaden:
www.create-store.com/nl



PL

Aby pobrać instrukcję w swoim języku, odwiedź naszą stronę internetową:
www.create-store.com/pl



INDEX

Box contents	6
Step 1. Wood roof	7
Step 1. Concrete ceiling	8
Step 1. False ceiling	10
Choice of height	11
Step 2. Main body assembly	12
Step 3. Earth connection	14
Step 4. Driver connection	15
Step 5. Blade assembly	17
Step 6. Fitting the trim	18
Step 7. Led board connection	19
Step 8. Attaching the lamp cover	20
Blade balancing kit	21

BOX CONTENTS

A



FLOWER

B



DRIVER

C



REMOTE CONTROL

D



LED PLATE

E



(x3) REVERSIBLE BLADES

F



LAMP COVER

G



EMBELLISHER

H



SUPPORT + ENGINE

I



SHANK

J



EXTENSION BAR

K



MOUNTING BRACKET

L



EMBELLISHER
THE MOTOR

M

(1) EXPANSION SCREWS



(2) WOOD SCREWS



N



SCREWS FOR
TRIM + ENGINE

P



SCREWS OF
THE BLADES

O



SPLICING TERMINALS

Q



BALANCING KIT



ATTENTION! Before starting the assembly, remember to disconnect the light from the electrical panel so as not to suffer an electric shock.

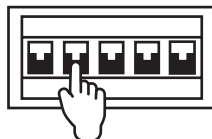

STEP 1. WOOD CEILING

PARTS AND TOOLS

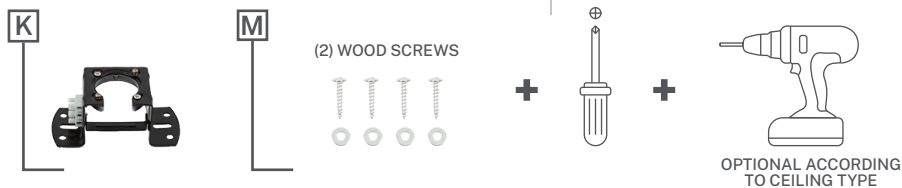

Mark on the ceiling with a pencil the 4 holes of piece **K**.

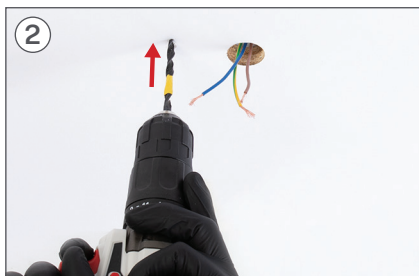

If necessary, depending on the type of ceiling, you will need to use a drill to make the hole in the wood.

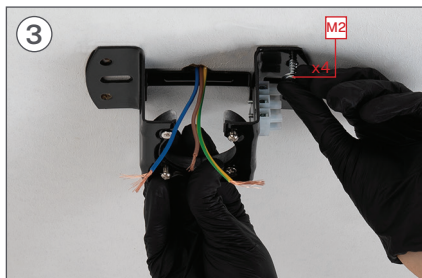

Place the washer and then the screw **M2**.

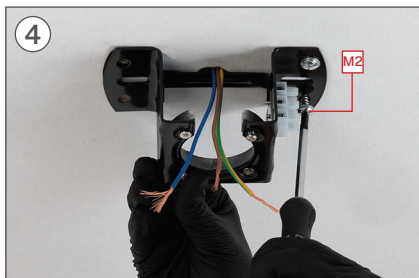

Using the screwdriver, tighten the screw **M2**.

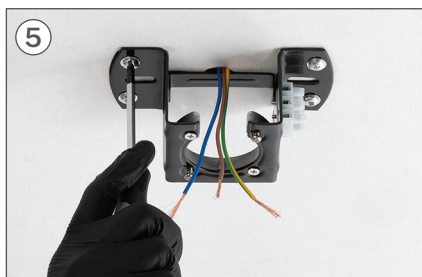

Repeat the previous step for the remaining holes.

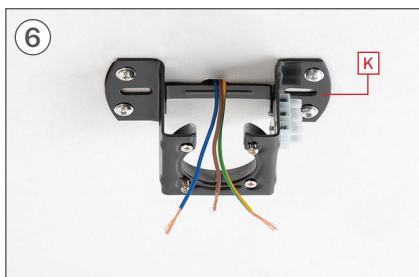

Make sure that part **K** is perfectly fixed to the ceiling and that no wires are trapped.

STEP 1. CONCRETE CEILING

PARTS AND TOOLS

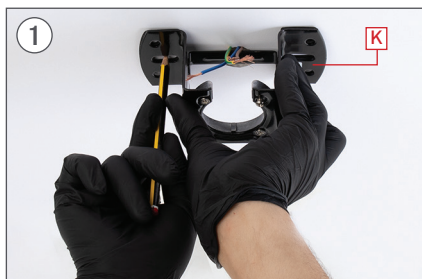
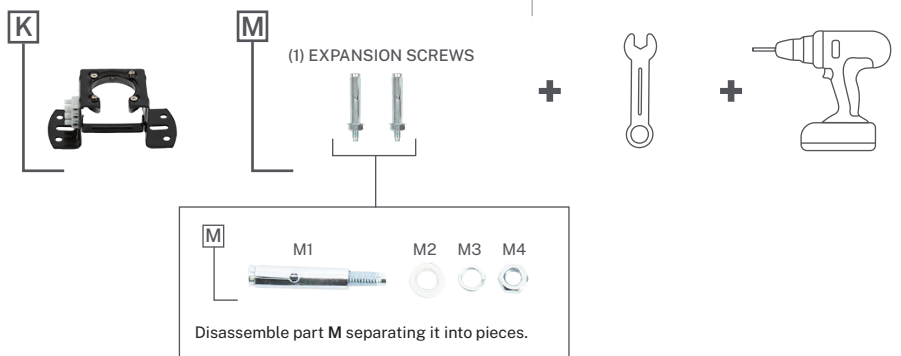

Mark on the ceiling with a pencil the 2 central holes of piece K, using the same piece as a guide.



With the help of a drill, make the two corresponding holes with an $\varnothing 8 \text{ mm}$ drill bit.

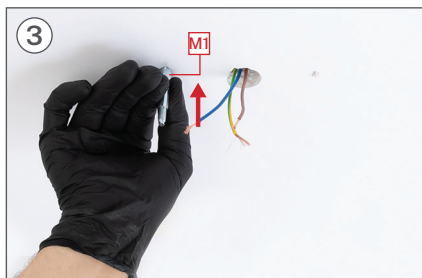

Place the pieces M1 in the holes on the ceiling.



Only the thread of the screw should stick out.

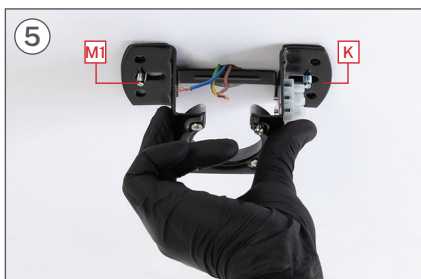

Place part **K** matching its holes with the screws **M1**. Make sure the ceiling wires are placed on one side of piece **K**.



Insert pieces **M2**, **M3** and subsequently the nut **M4**.

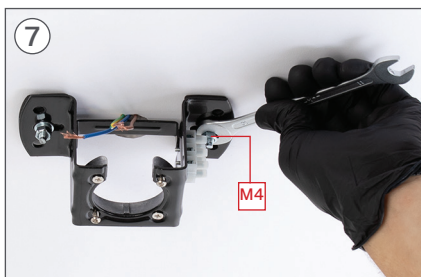

Tighten piece **M4** with a # 10 wrench, until you feel that it is well fixed.

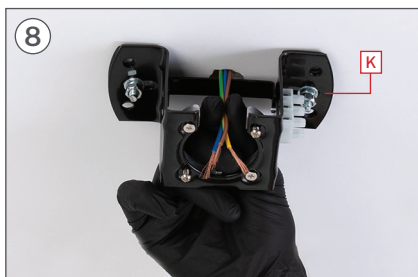

Make sure that piece **K** is perfectly hooked to the ceiling and that no wires are trapped.

STEP 1. FALSE CEILING

PARTS AND TOOLS



Mark on the ceiling with a pencil the 2 central holes using piece K as a guide.

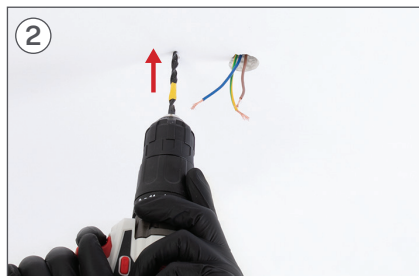

With the help of a drill, make the two corresponding holes.



Insert the fixing screws into the holes and make sure the lever opens.

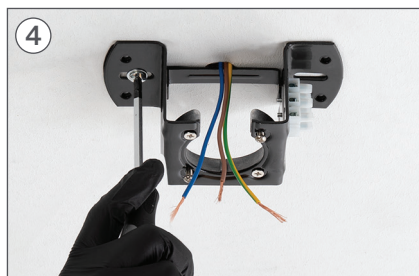

Place piece K and screw the fixing screws to the false ceiling.

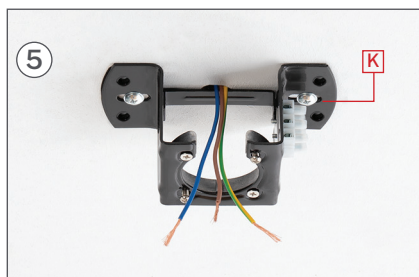

Make sure that part K is perfectly attached to the ceiling to continue with the assembly.

CHOICE OF HEIGHT

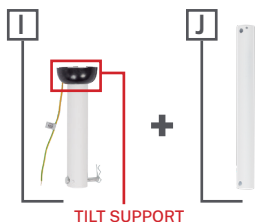

Before you start, choose the desired height.
(10cm+/-)

You will have to choose between the height of the piece I wave J.

- If you choose the height of the piece J, You must follow the instructions below.
- If you choose the height of the piece I, go directly to step 2 (page 12).



Using a screwdriver, remove the two screws on the bar tilt bracket I.



Slide the tilt stand down.



Remove the pin from the tilt bracket.



Remove the tilt bracket from the bar I.



Pull out the bar pin locking piece I.



Carefully remove the pin from the bar I.



Attach the tilt bracket to the bar J.



Place the pin of the tilt support on the bar J.



10 Snap the tilt bracket onto the pin.



11 Tighten the two screws on the tilt bracket with the screwdriver.

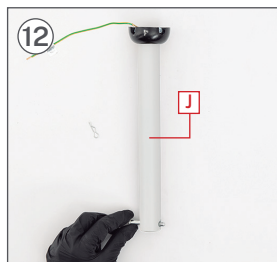

12 Put the pin back in the piece J.



13 Secure the pin with the locking piece so that it does not come out.

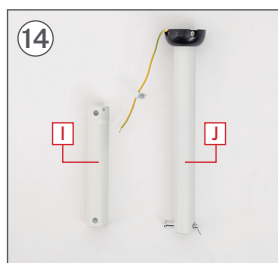

14 The piece J It would be ready to use.

STEP 2. MAIN BODY ASSEMBLY

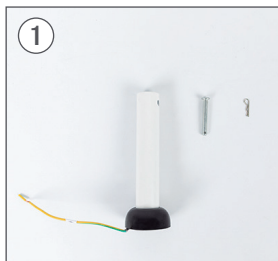
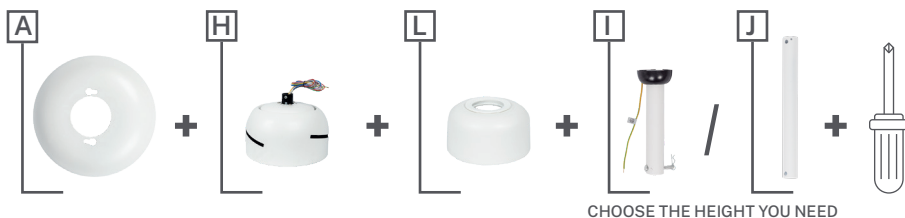

Remove the pin from the part I either J, depending on the chosen height.



Enter the chosen bar through the hole in the part A.

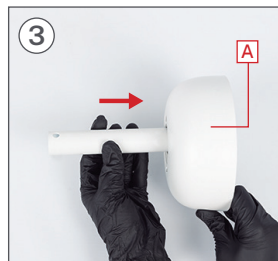

Insert the piece L As shown in the picture.



Once the pieces are inserted A and L, you must insert the cables of the part H inside the bar. If you wish, you can tape the wires to make them easier to handle.

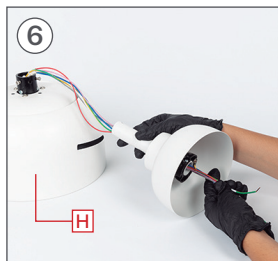

With the help of a screw-driver, remove the screws from the top of the piece H.



Insert the bar at the top of the part H.



Make sure no wires get pinched.



Once the bar has been inserted, place the pin of the part I/J so that it coincides with the hole in the bar.



Put the locking piece on the pin so that it does not come out.

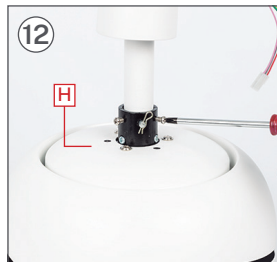

Then replace the screws on the part H so that the bar is fully secured.



Once the bar is well anchored to the piece H, slide piece L down. The main body of the fan motor will be assembled.



STEP 3. DRIVER CONNECTION

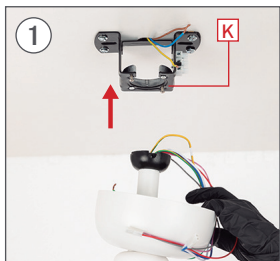
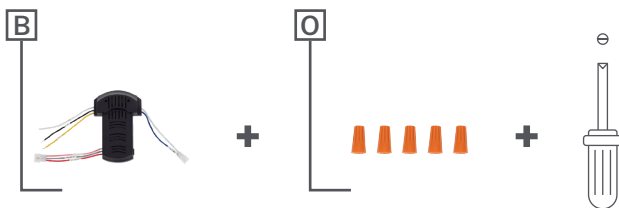

Put the tilt bracket into the slot on the part K.



Remember to set the notch on the tilt bracket back so that the piece fits snugly.

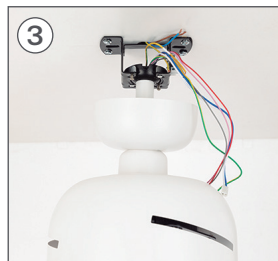

Before continuing, check that the central structure is well placed so that it does not fall.

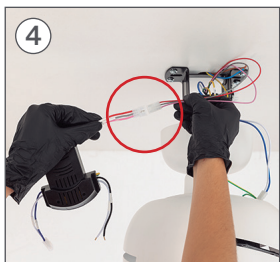

Join the part connections B with the motor connections, each with its corresponding color.

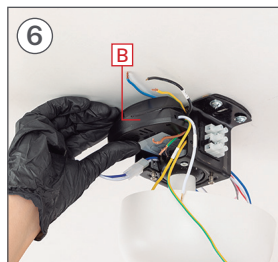
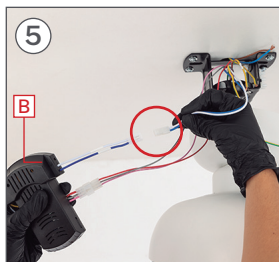

Once the cables are connected, insert the part B inside the piece K, As shown in the picture.

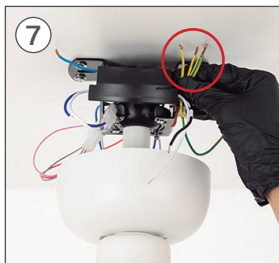

Select and connect the ground cables, including the one for your installation.

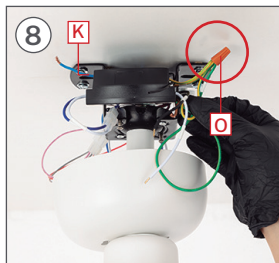

Once connected, place the pieces **O** screwing them until they are secure.



You will need to attach the remaining wires from the piece **B** and the phase and neutral cables of its installation in the strip of the piece **O**, as it's shown in the following.

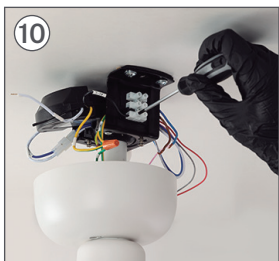

Connect the **LINE** cable of the driver (**AC-L**) to the **PHASE** cable of your installation.



Connect the **NEUTRAL** cable of the driver (**AC-N**) to the **NEUTRAL** cable of your installation.

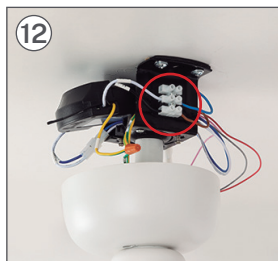

Make sure no wires are pinched.



Slide piece **A** upwards to fit it on the protruding screws of the piece **K**.



Once fitted, turn the piece **A** to the right.

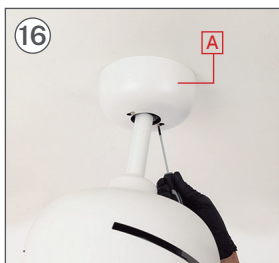

Finally, with the help of a screwdriver, tighten the screws so that the piece is well fixed.

STEP 4. BLADE ASSEMBLY



+

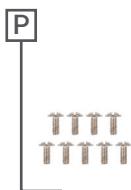

+



CHOOSE THE COLOR OF THE BLADE

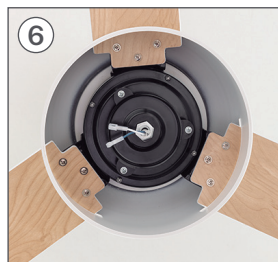
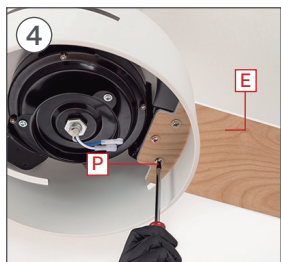
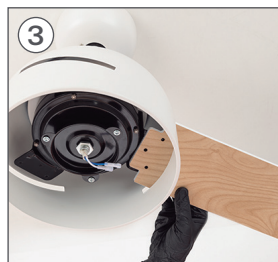
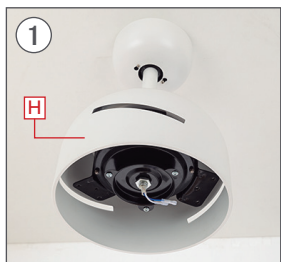

Once you have placed the blade E, screw it with 3 of the screws (part P). Repeat the step with the remaining blades, making sure they are perfectly attached.

STEP 5. FITTING THE TRIM

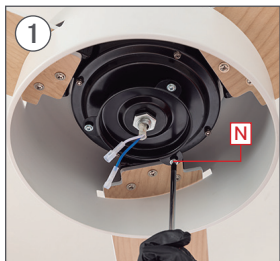
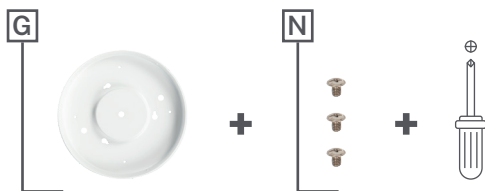

Using a screwdriver, remove the 3 center screws from the motor for later use. If these screws come separately in a sealed bag, use them for this step.

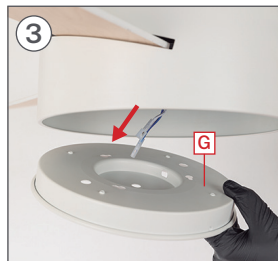
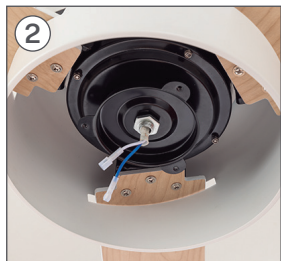

Pass the motor cables through the hole on the side of the piece G.



Place the piece G aligning its holes with the holes in the motor.



Firmly tighten the screws so that the part G is properly fastened.

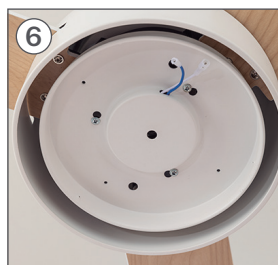

STEP 6. LED BOARD CONNECTION

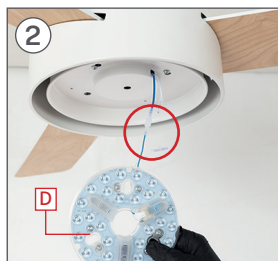
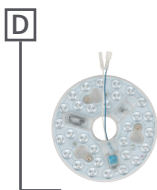

Connect the part wires D to those of the fan joining the connections, each cable with its same color.

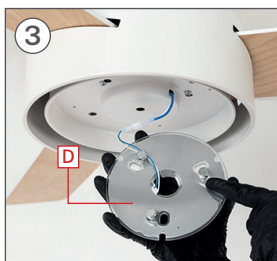

Then attach the part D to the piece G with the help of the magnets so that it remains attached.

STEP 7. ATTACHING THE LAMP COVER

F

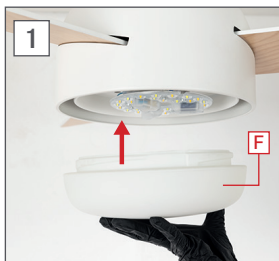

Place the piece **F** on the fan by snapping it onto the motor and secure it by turning clockwise. Don't forget to check that the part **G** it is well attached. Once checked, you can connect the electricity and enjoy your new fan with light.



Once checked, you can connect the electricity and enjoy your new fan with light.

BLADE BALANCING KIT

Q

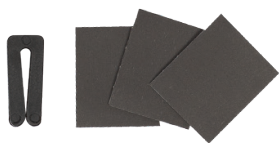

Your ceiling fan may have blade swing problems when in operation due to irregularities in the blades or brackets. Also, incorrect system mounting or crooked bearings could cause additional problems. The following procedure is recommended to remedy these problems:

1. Make sure the blades are firmly screwed to their brackets.
2. Make sure all blades are firmly secured to the center swivel casing and check the inclination of the blade mounts, they should all be the same.
3. Standing under the fan and looking up, check that none of the blade supports are bent so that none of the blades are misplaced. You can correct the position of the blade holders by gently bending them to the correct position.
4. You can check the height of the blades with a simple school ruler. Place the ruler against the ceiling vertically and level with the outside of the blade tip. Check the distance from the blade tip to the ceiling, carefully rotate the blades by hand and check the rest of the blades. If the blades are not aligned, you can carefully bend the blade holder up or down slightly to align with each other.

If the balance problem is not solved even by following the steps above, you must perform a dynamic balance using the kit provided. Follow the procedure below:

1. Turn on the fan and set the speed at which the greatest sway is created (usually occurs at the highest speed).
2. Turn off the fan. Select a blade and place the balancing clip, midway between the bracket and the tip, on the rear edge of the blade.
3. Turn on the fan. Wait to see if the sway has improved or worsened. Turn the fan off again and attach the clip to another blade to retest. Repeat this process with all the blades and check which one has improved the most.
4. Place the clip on the blade that has improved the most. Move it in or out of the blade and run the fan to find the best position where the clip offers the greatest roll improvement.
5. Then remove the clip and install a balancing weight on top of the blade on the center line near the point where the clip was placed. Use a knife or blade if necessary to separate the weights.

Watch out: Stand at a safe distance from the blades. If the clip has not been properly secured, for any reason, you could be injured.

[illegible]

[illegible]

CREATE