

CREATE

WIND CALM

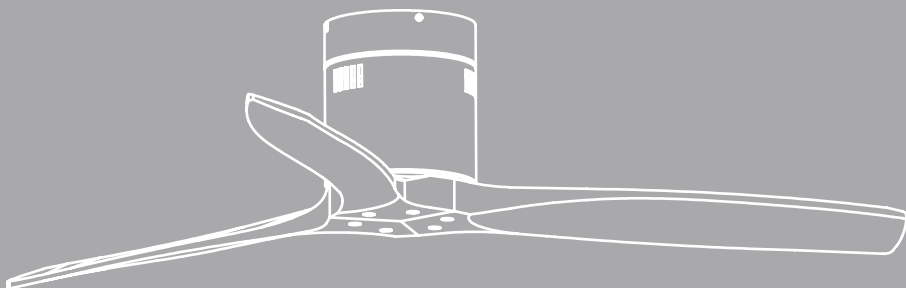

CEILING FAN WITHOUT LIGHT

ASSEMBLY MANUAL

[illegible]



EN

To download this user guide in your language, visit our website:
www.create-store.com/uk/



ES

Para descargar el manual en su idioma, visite nuestra web:
www.create-store.com/es/



PT

Para baixar o manual no seu idiomas, visite nosso site:
www.create-store.com/pt/



FR

Pour télécharger le manuel dans votre langue, visitez notre site Web:
www.create-store.com/fr/



IT

Per scaricare il manuale nella sua lingua, visitare il nostro sito Web:
www.create-store.com/it/



DE

Um das Handbuch in Ihrer Sprachen herunterzuladen, besuchen Sie unsere Website:
www.create-store.com/de/



NL

Bezoek onze website om de handleiding in uw taal te downloaden:
www.create-store.com/nl/



PL

Aby pobrać instrukcję w swoim języku, odwiedź naszą stronę internetową:
www.create-store.com/pl/

THIS MANUAL IS FOR ALL WINDCALM



INDEX

Box contents	5
Step 1. Wood ceiling	6
Step 1. Concrete ceiling	7
Step 1. False ceiling	9
Step 2. Driver connection	10
Step 4. Anchoring the motor to the ceiling	12
Step 5. Assembling the blades	13
Blade balancing kit	14

BOX CONTENTS

A



MOUNTING BRACKET

B



DRIVER

C



REMOTE CONTROL

D

(1) EXPANSION SCREWS



(2) WOOD SCREWS



E



BLADES

F



MOTOR BRACKET

G

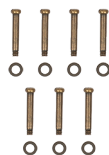

SCREWS + WASHERS FOR
BLADES

H



SCREWS FOR
BRACKET + MOTOR

I



WIRE CONNECTORS

J

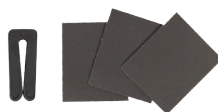

BALANCING KIT



ATTENTION! Before starting the assembly, remember to disconnect the light from the electrical panel so as not to suffer an electric shock.

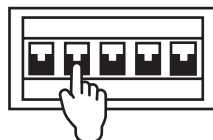

STEP 1. WOOD CEILING

PARTS AND TOOLS

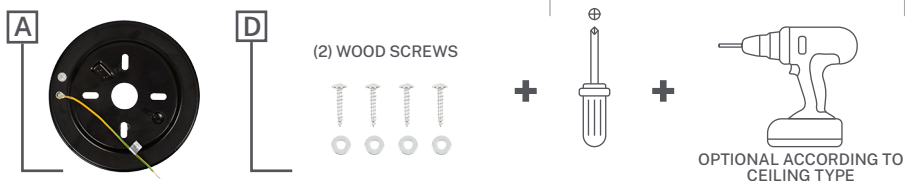

Mark with a pencil the 4 holes of piece A on the ceiling.



If necessary, depending on the type of ceiling, you will need to use a drill to make the holes in the wood.



Place the washer and then the screw D2 with the help of the screwdriver.



Repeat this step for the remaining 3 holes.



Make sure that piece A is perfectly hooked to the ceiling with the screws well tightened.

STEP 1. CONCRETE CEILING

PARTS AND TOOLS

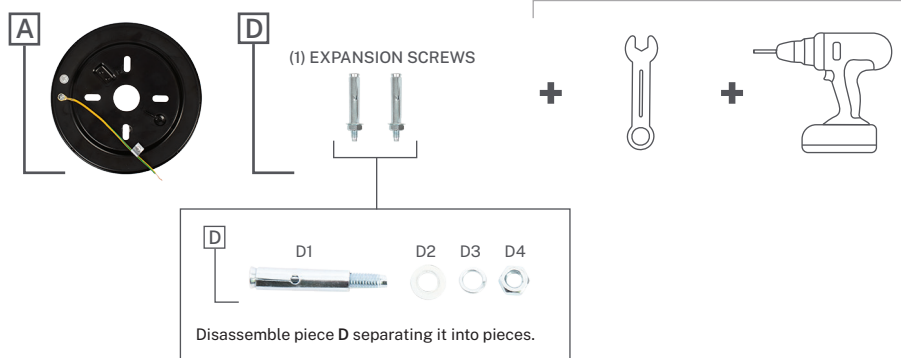

Mark 2 parallel holes on the ceiling with a pencil using piece A as a guide.



Using a drill, make the two corresponding holes with a Ø8 mm drill bit.

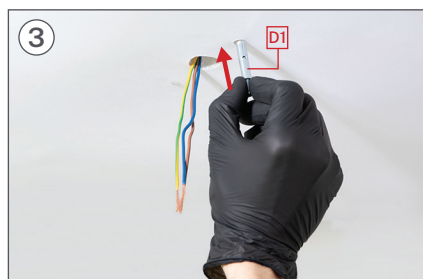

Insert the pieces D1 in the holes of the ceiling.



Place piece A matching its holes with the screws D. Make sure the ceiling wires pass through the center hole of piece A.



Insert piece **D2**, **D3** and the nut **D4** following this order.

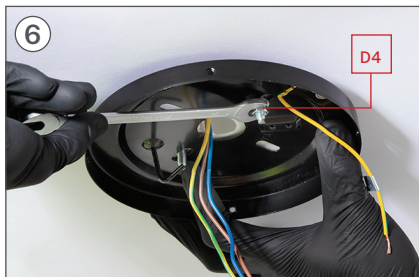

Tighten piece **D4** with a number 10 wrench, until they are well fixed.

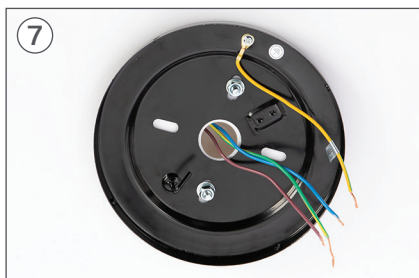

Make sure that piece **A** is perfectly hooked to the ceiling.

STEP 1. FALSE CEILING

PIECES AND TOOLS

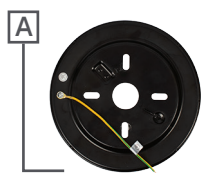

+

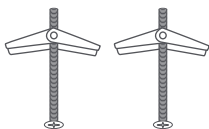

FIXING SCREWS
WITH SPRING LEVER

+



+

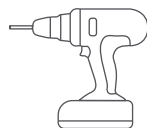

NOT INCLUDED



Mark 2 parallel holes on the ceiling with a pencil using piece A as a guide.



With the help of a drill, make the two corresponding holes.



Insert the fixing screws into the holes and make sure the lever opens.



Place piece A and screw the fixing screws to the false ceiling.



Make sure that piece A is perfectly attached to the ceiling.

STEP 2. DRIVER CONNECTION

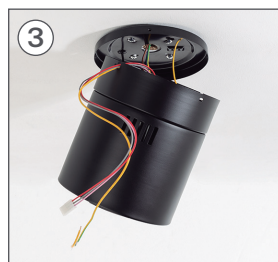
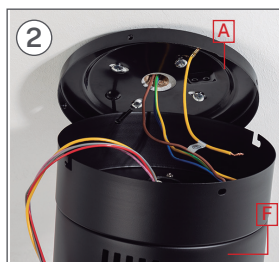
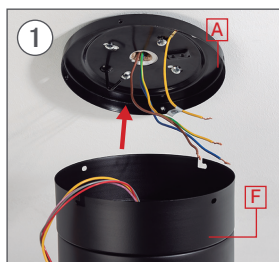
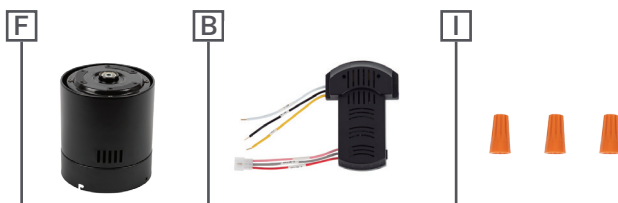

Insert the hook you can find in piece A in a hole in piece F so that the motor is hanging to facilitate the connection of the wires.

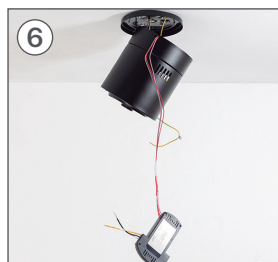

Join the connections of piece F with the ones in piece B, each one with its corresponding color.

Make sure the main structure is properly placed.

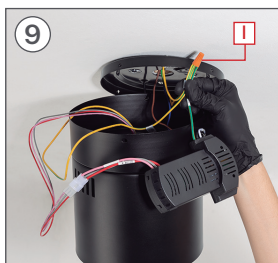

Select and connect all the grounding wires, including the one from your house wiring.

Once connected, place piece I screwing it until it is well tighten.



Connect the NEUTRAL wire from the driver (AC-N) with the NEUTRAL wire from your house wiring.

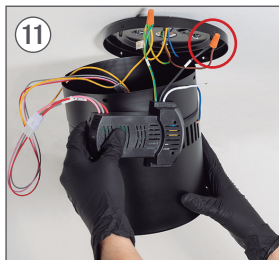

Once connected, place piece I screwing it until it is well tighten.



Connect the LINE wire from the driver (AC-L) with the LINE wire from your house wiring. Once connected, place piece I screwing it.

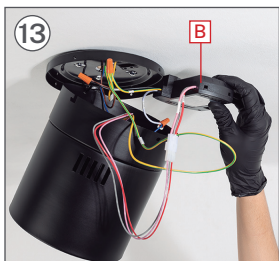

Once all the wires are connected, insert piece B inside piece F, as shown in the image.



STEP 4. ANCHORING THE MOTOR TO THE CEILING

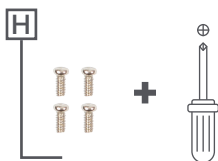

Use 2 screws **H** and screw them loosely into the parallel holes in piece **A**.



Remove piece **F** from the hook and snap it into piece **A** without pinching any wire.



Once docked in the hole, turn piece **F** to the right and check that it is properly seated without pinching any wires.



Once piece **F** is fitted, fit the 2 screws **H** into the remaining holes by tightening them with the screwdriver. Then tighten the first 2 screws to secure them.

STEP 5. ASSEMBLING THE BLADES

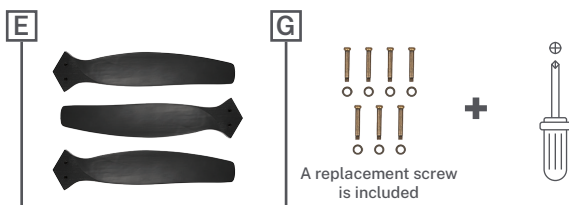

Place the first blade E securing it with the washers and screws G with the help of the screwdriver, without tightening them too much, to be able to put the rest of the blades.

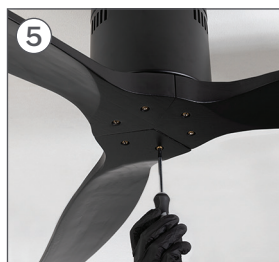

Follow the same step with the second and third blades E. Once all the blades E are in place, screw all the screws G tightly so that the blades are well attached.

BLADE BALANCING KIT



Your ceiling fan may have blade swing problems when in operation due to irregularities in the blades or brackets. Also, incorrect system mounting or crooked bearings could cause additional problems. The following procedure is recommended to remedy these problems:

1. Make sure the blades are firmly screwed to their brackets.
2. Make sure all blades are firmly secured to the center swivel casing and check the inclination of the blade mounts, they should all be the same.
3. Standing under the fan and looking up, check that none of the blade supports are bent so that none of the blades are misplaced. You can correct the position of the blade holders by gently bending them to the correct position.
4. You can check the height of the blades with a simple school ruler. Place the ruler against the ceiling vertically and level with the outside of the blade tip. Check the distance from the blade tip to the ceiling, carefully rotate the blades by hand and check the rest of the blades. If the blades are not aligned, you can carefully bend the blade holder up or down slightly to align with each other.

If the balance problem is not solved even by following the steps above, you must perform a dynamic balance using the kit provided. Follow the procedure below:

1. Turn on the fan and set the speed at which the greatest sway is created (usually occurs at the highest speed).
2. Turn off the fan. Select a blade and place the balancing clip, midway between the bracket and the tip, on the rear edge of the blade.
3. Turn on the fan. Wait to see if the sway has improved or worsened. Turn the fan off again and attach the clip to another blade to retest. Repeat this process with all the blades and check which one has improved the most.
4. Place the clip on the blade that has improved the most. Move it in or out of the blade and run the fan to find the best position where the clip offers the greatest roll improvement.
5. Then remove the clip and install a balancing weight on top of the blade on the center line near the point where the clip was placed. Use a knife or blade if necessary to separate the weights.

Watch out: Stand at a safe distance from the blades. If the clip has not been properly secured, for any reason, you could be injured.

[illegible]

CREATE