

# CREATE

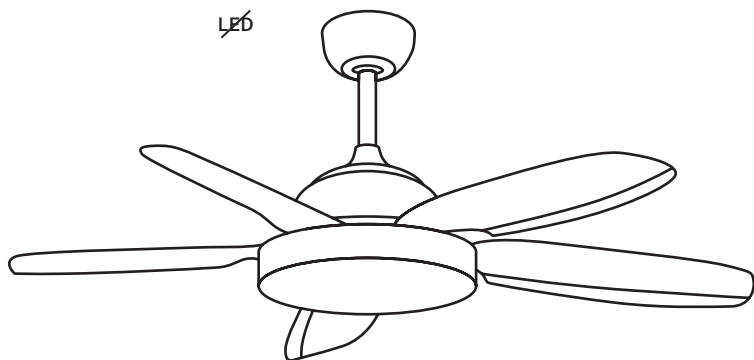
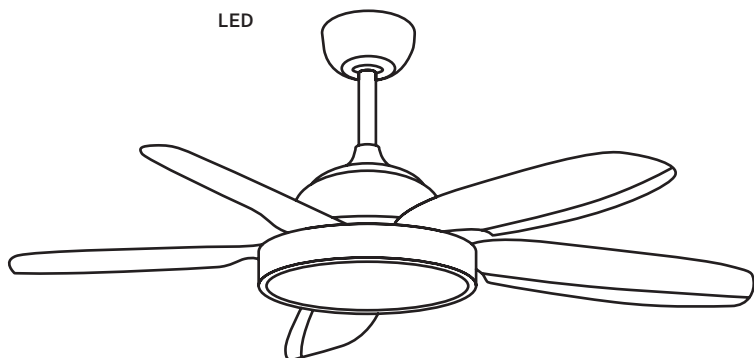

## Wind Flat

---

Assembly manual

[illegible]

[illegible]

# CREATE



## EN

To download this user guide in your language, visit our website:  
[www.create-store.com/uk](http://www.create-store.com/uk)



## ES

Para descargar el manual en su idioma, visite nuestra web:  
[www.create-store.com/es](http://www.create-store.com/es)



## PT

Para baixar o manual no seu idiomas, visite nosso site:  
[www.create-store.com/pt](http://www.create-store.com/pt)



## FR

Pour télécharger le manuel dans votre langue, visitez notre site Web:  
[www.create-store.com/fr](http://www.create-store.com/fr)



## IT

Per scaricare il manuale nella sua lingua, visitare il nostro sito Web:  
[www.create-store.com/it](http://www.create-store.com/it)



## DE

Um das Handbuch in Ihrer Sprachen herunterzuladen, besuchen Sie unsere Website:  
[www.create-store.com/de](http://www.create-store.com/de)



## NL

Bezoek onze website om de handleiding in uw taal te downloaden:  
[www.create-store.com/nl](http://www.create-store.com/nl)



## PL

Aby pobrać instrukcję w swoim języku, odwiedź naszą stronę internetową:  
[www.create-store.com/pl](http://www.create-store.com/pl)



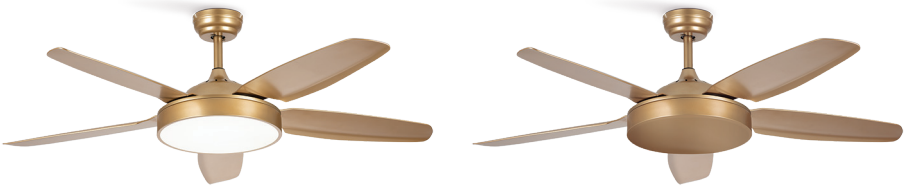

## INDEX

---

Box content	6
Step 1. Wood ceiling	7
Step 1. Concrete ceiling	8
Step 1. False ceiling	10
Step 2. Main body assembly	11
Step 3. Driver connection	13
Step 4. Assembling the blades	15
Step 5. Placing the decorative element	16
OPTION WITH LED KIT	17
Step 6. Led plate connection	17
Step 7. Placing the lamp cover	18
OPTION WITHOUT LED KIT	19
Step 8. Fitting the cover	19
Blade balancing kit	21

# BOX CONTENT

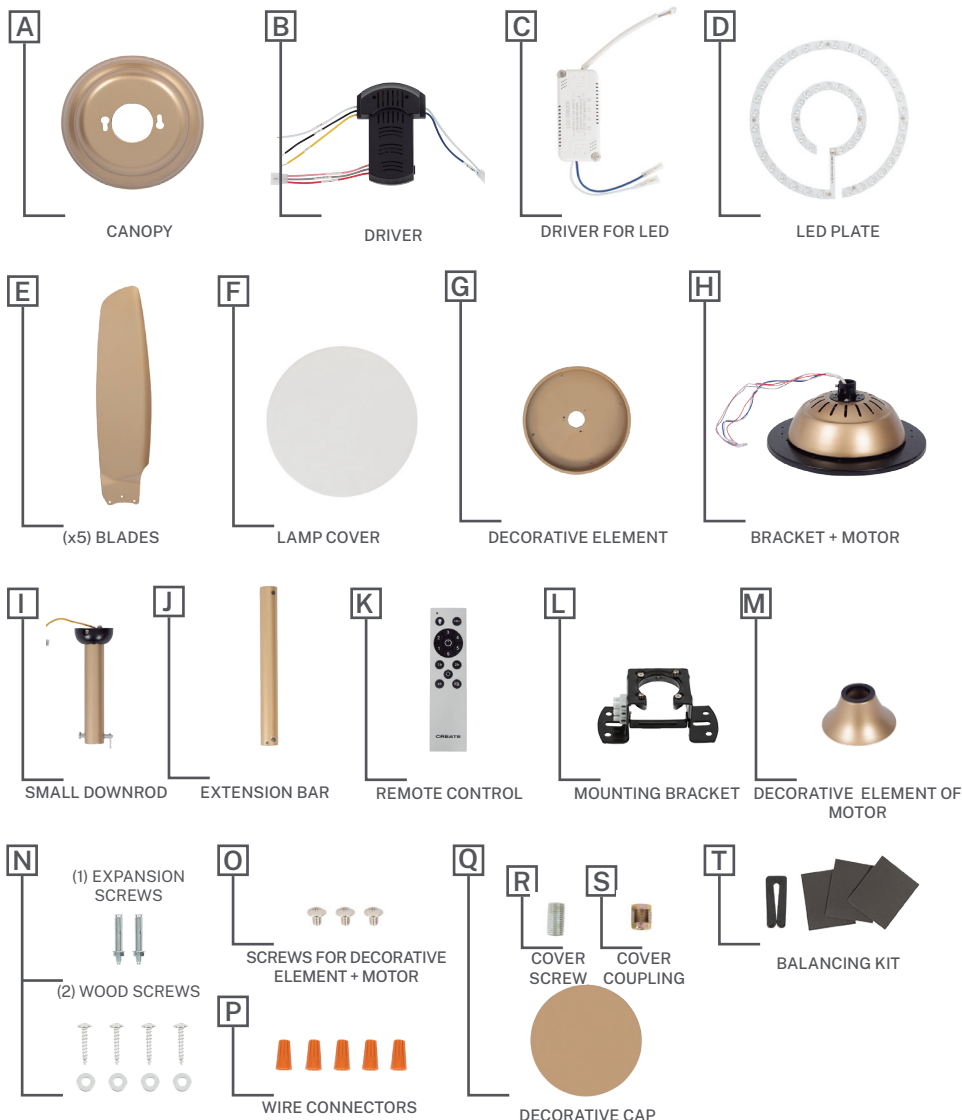

**ATTENTION!** Before starting the assembly, remember to disconnect the light from the electrical panel so as not to suffer an electric shock.

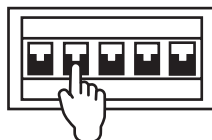

# STEP 1. WOOD CEILING

## PARTS AND TOOLS

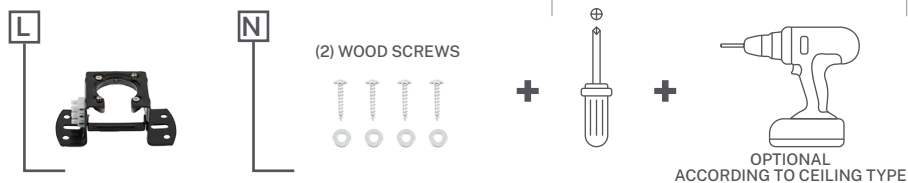

Mark on the ceiling with a pencil the 4 holes of piece L.

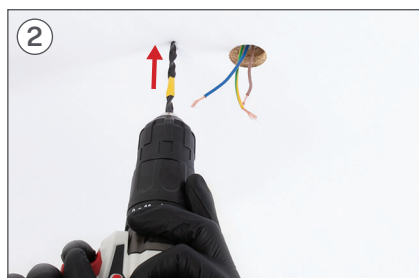

If necessary, depending on the type of ceiling, you will need to use a drill to make the hole in the wood.

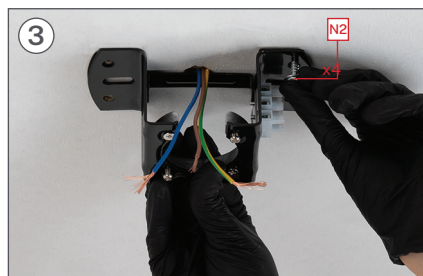

Place the washer and then the screw N2.

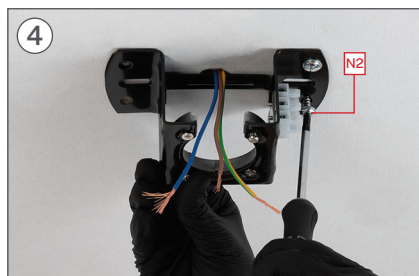

Using the screwdriver, tighten the screw N2.

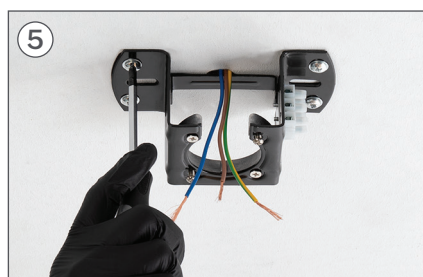

Repeat the previous step for the remaining holes.

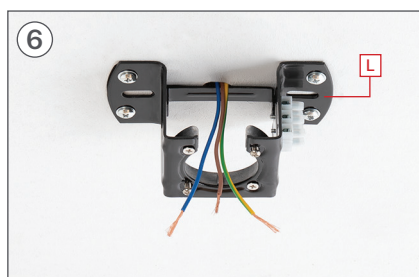

Make sure that part L is perfectly fixed to the ceiling and that no wires are trapped.

# STEP 1. CONCRETE CEILING

## PARTS AND TOOLS

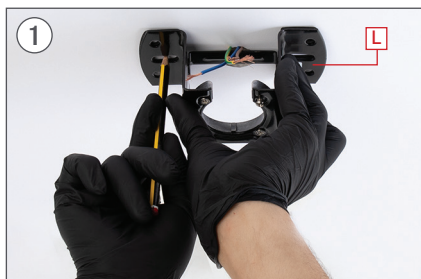
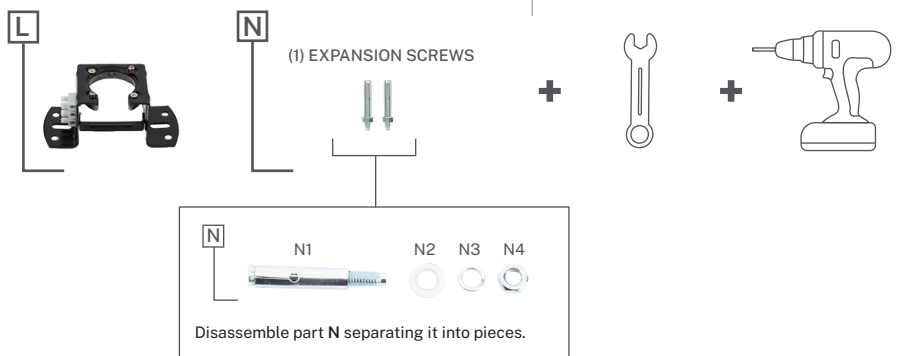

Mark on the ceiling with a pencil the 2 central holes of piece L, using the same piece as a guide.



With the help of a drill, make the two corresponding holes with an Ø8 mm drill bit.

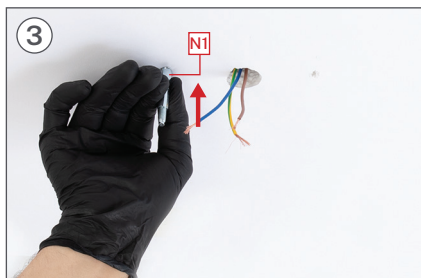

Place the pieces N1 in the holes on the ceiling.



Only the thread of the screw should stick out.

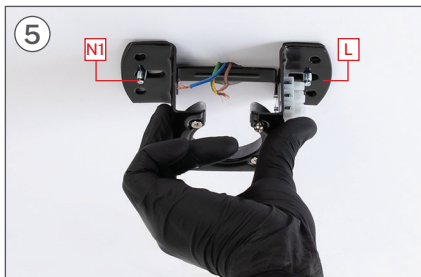

Place part **L** matching its holes with the screws **N1**. Make sure the ceiling wires are placed on one side of piece **L**.



Insert pieces **N2**, **N3** and subsequently the nut **N4**.

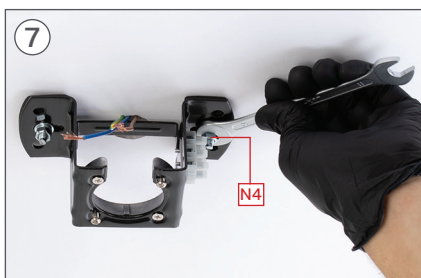

Tighten piece **N4** with a # 10 wrench, until you feel that it is well fixed.

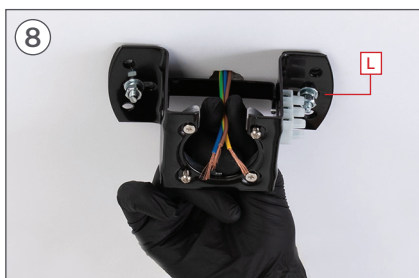

Make sure that piece **L** is perfectly hooked to the ceiling and that no wires are trapped.

# STEP 1. FALSE CEILING

## PARTS AND TOOLS

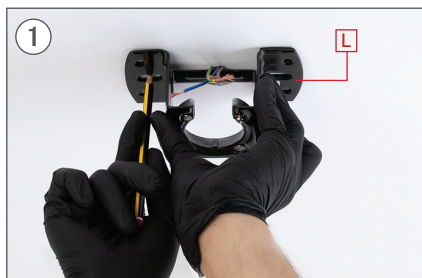

Mark on the ceiling with a pencil the 2 central holes using piece L as a guide.



With the help of a drill, make the two corresponding holes.



Insert the fixing screws into the holes and make sure the lever opens.

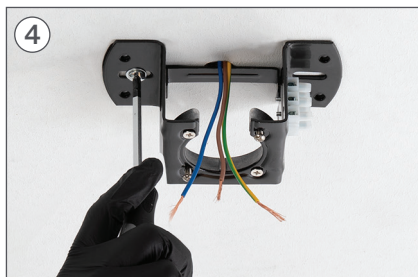

Place piece L and screw the fixing screws to the false ceiling.

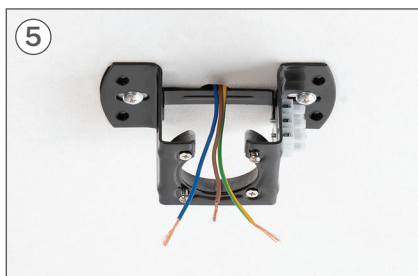

Make sure that part L is perfectly attached to the ceiling to continue with the assembly.

## STEP 2. MAIN BODY ASSEMBLY

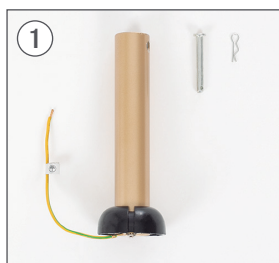
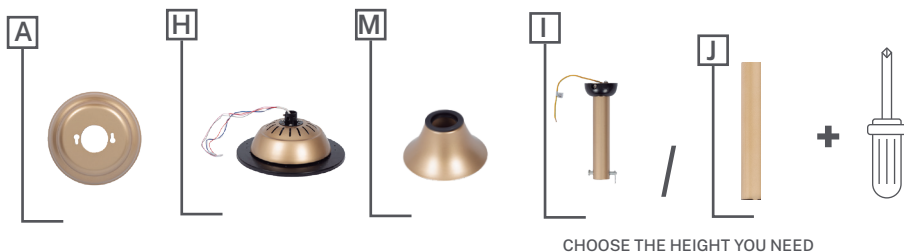

Remove the pin from part I.

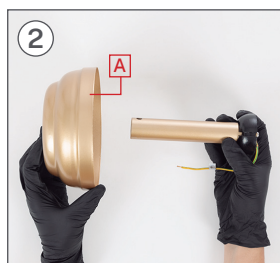

Insert the bar through the hole in part A.



Insert part M as shown in the picture.

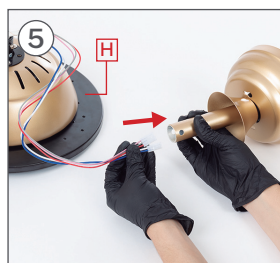

Once the pieces A and M are inserted, you must insert the wires of part H inside the bar. If you want, you can tape the wires down to make it easier to run them inside the bar.

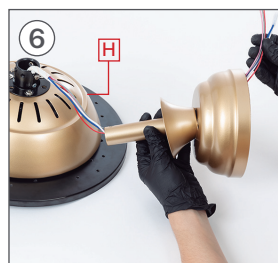





With the help of a screwdriver, remove the 2 screws at the top of piece H.



Insert the bar at the top of piece H.



Make sure no wires are pinched.



Once the bar is inserted, place the pin of piece I so that it matches the hole in the bar.



Place the locking piece on the pin so that it does not come off.



Then replace the two screws so that the bar is fully secured.



Once the bar is well anchored to piece H, slide piece M down. The main frame of the fan motor will remain assembled.



## STEP 3. DRIVER CONNECTION

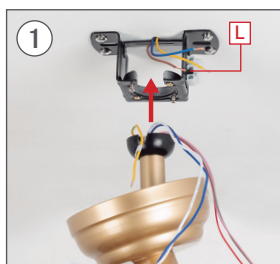
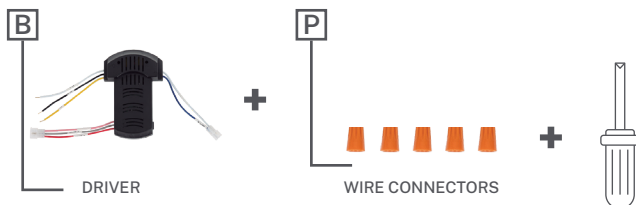

Place the tilt support in the slot of piece L.

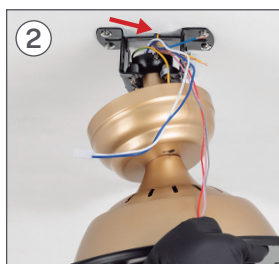

Remember to put the notch of the black top of the tilt support backwards so that the piece fits properly.

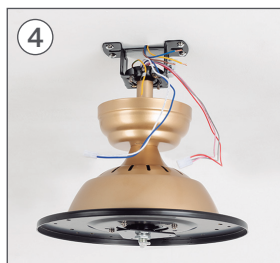
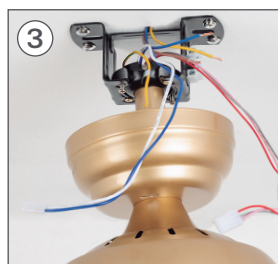

Before continuing, check that the center frame is securely positioned so that it does not fall.



Once the wires are connected, insert piece B inside piece L, as shown in the image.

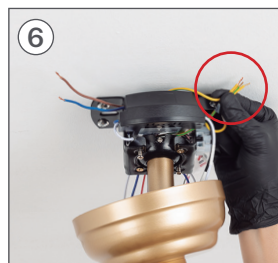

Select and connect all the grounding wires together, including the one from your own house wiring.

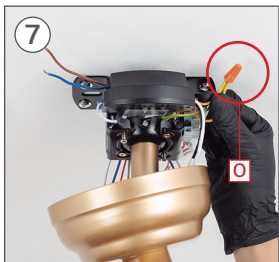

Once connected, place piece P screwing it until it is well tighten.

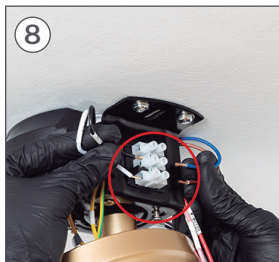

Then, you have to join the remaining wires of piece B and the line and neutral wires from your house wiring in the block terminal in piece L, as shown below.

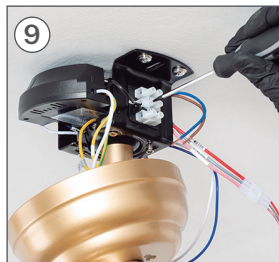

Connect the L wire from the driver with the LINE wire from your house wiring.

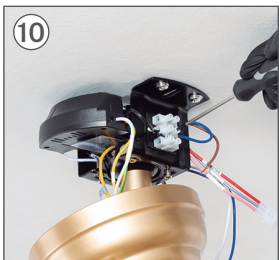

Connect the N wire from the driver with the neutral wire from your house wiring.

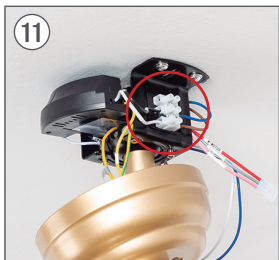

Make sure the wires aren't pinched.



Slide part A up to fit the screws protruding from piece L.



Once fitted, turn piece A to the right.

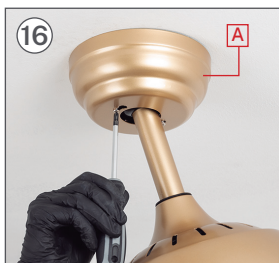

Finally, with the help of a screwdriver, tighten the screws so that the piece is well fixed.

## STEP 4. ASSEMBLING THE BLADES

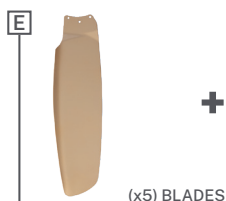

Remove the 15 screws from the bottom of piece H to be used later in the assembly of the blades.



Insert one blade E in one of the grooves of piece H until it is positioned correctly. Once you have placed a blade E, screw it in with 3 of the screws from step 1.



Repeat the step with the 4 remaining blades making sure that they are perfectly attached.

## STEP 5. PLACING THE DECORATIVE ELEMENT

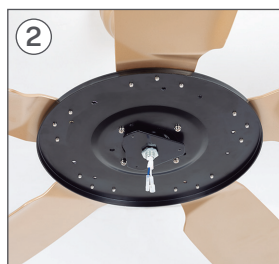
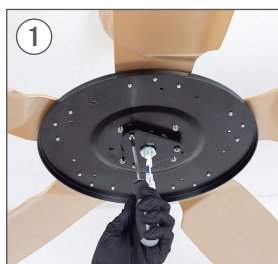
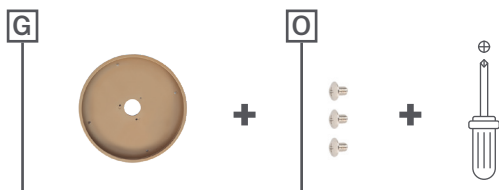

With a screwdriver remove the 3 central screws of the motor to use them later.

Pass the motor wires through the center hole of piece G.



Place piece **G** aligning its holes with the holes in the motor.



Firmly tighten the screws removed in step 1 so that piece **G** is properly attached.



## OPTION WITH LED KIT

### STEP 6. LED PLATE CONNECTION

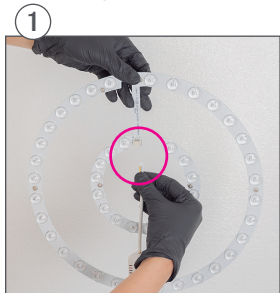
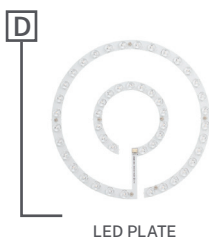
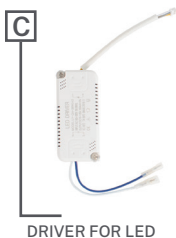

Connect the wires of the driver **C** with those of the LED plate **D** by joining the connectors.

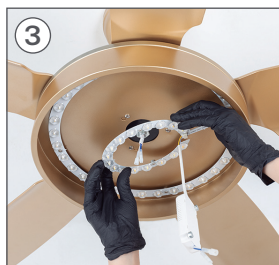
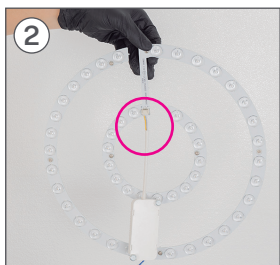

Once connected, place the LED plate inside of piece **G** with the help of the magnets.





Next, place the driver on piece **G** where the magnets are without covering any LEDs.

## STEP 7. PLACING THE LAMP COVER

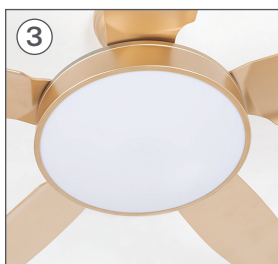
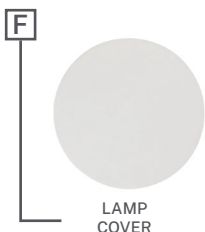

Place piece **F** on piece **G** until it fits correctly, as shown in the image. Please make sure that piece **F** is securely fastened. Once you have checked, you can turn on the power and enjoy your new ceiling fan with light.

## OPTION WITHOUT LED KIT

### STEP 8. FITTING THE COVER

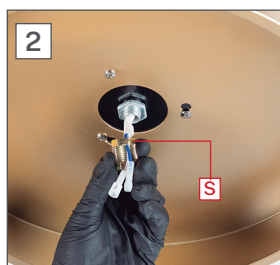
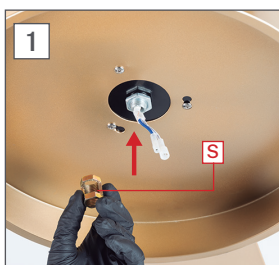
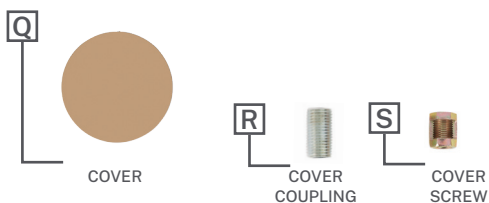

Carefully insert the fan wires inside piece **S** and take them out through the large side hole of this piece. Then screw piece **S** and check that it remains securely attached to the fan.

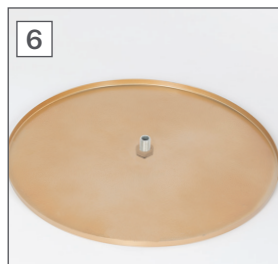
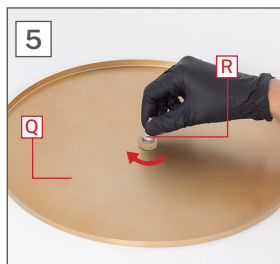
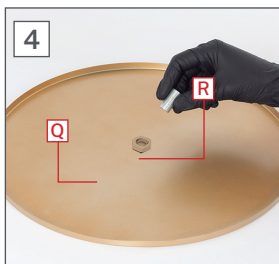

Take piece **Q** and tighten the screw **R** into the hole so that it is securely attached.

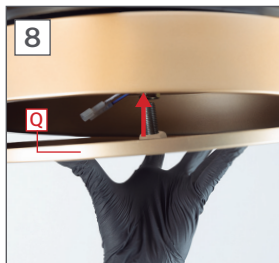
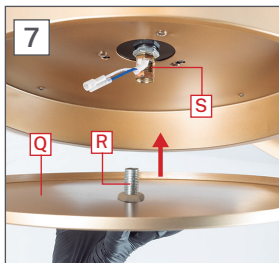

Then take the piece Q and tighten the screw R on the nut S previously placed on the fan. Once the piece is in place, you can connect the electricity and enjoy your new fan.





## BLADE BALANCING KIT

T



Your ceiling fan may have blade swing problems when in operation due to irregularities in the blades or brackets. Also, incorrect system mounting or crooked bearings could cause additional problems. The following procedure is recommended to remedy these problems:

1. Make sure the blades are firmly screwed to their brackets.
2. Make sure all blades are firmly secured to the center swivel casing and check the inclination of the blade mounts, they should all be the same.
3. Standing under the fan and looking up, check that none of the blade supports are bent so that none of the blades are misplaced. You can correct the position of the blade holders by gently bending them to the correct position.
4. You can check the height of the blades with a simple school ruler. Place the ruler against the ceiling vertically and level with the outside of the blade tip. Check the distance from the blade tip to the ceiling, carefully rotate the blades by hand and check the rest of the blades. If the blades are not aligned, you can carefully bend the blade holder up or down slightly to align with each other.

If the balance problem is not solved even by following the steps above, you must perform a dynamic balance check using the kit provided. Follow the procedure below:

1. Turn on the fan and set the speed at which the most sway is created (usually this occurs at the highest speed).
2. Turn off the fan. Select a blade and place the balancing clip, midway between the bracket and the tip, on the rear edge of the blade.
3. Turn on the fan. Wait to see if the sway has improved or worsened. Turn the fan off again and attach the clip to another blade to retest. Repeat this process with all the blades and check which one has improved the most.
4. Place the clip on the blade that has improved the most. Move it in or out of the blade and run the fan to find the best position where the clip offers the greatest roll improvement.
5. Then remove the clip and install a balancing weight on top of the blade on the center line near the position where the clip was placed. Use a knife or blade if necessary to separate the weights.

**Caution:** Stand at a safe distance from the blades. If for any reason the clip has not been properly secured, you could be injured.V

[illegible]

[illegible]

**CREATE**